

Finished basement floor area = 785 ft²

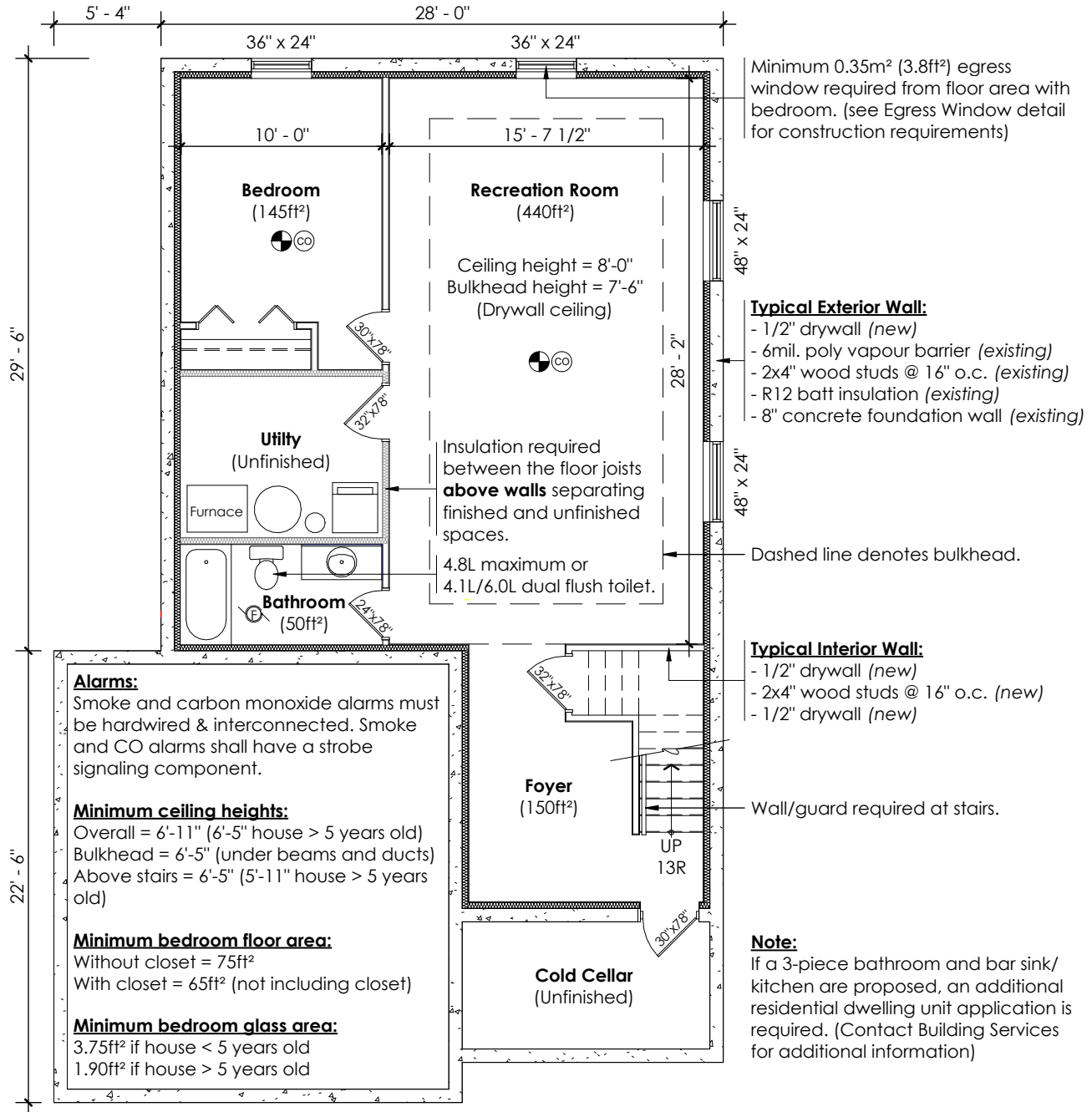

Alarms:
Smoke and carbon monoxide alarms must be hardwired & interconnected. Smoke and CO alarms shall have a strobe signaling component.

Minimum ceiling heights:
Overall = 6'-11" (6'-5" house > 5 years old)
Bulkhead = 6'-5" (under beams and ducts)
Above stairs = 6'-5" (5'-11" house > 5 years old)

Minimum bedroom floor area:
Without closet = 75ft²
With closet = 65ft² (not including closet)

Minimum bedroom glass area:
3.75ft² if house < 5 years old
1.90ft² if house > 5 years old

Minimum 0.35m² (3.8ft²) egress window required from floor area with bedroom. (see Egress Window detail for construction requirements)

Typical Exterior Wall:
- 1/2" drywall (new)
- 6mil. poly vapour barrier (existing)
- 2x4" wood studs @ 16" o.c. (existing)
- R12 batt insulation (existing)
- 8" concrete foundation wall (existing)

Typical Interior Wall:
- 1/2" drywall (new)
- 2x4" wood studs @ 16" o.c. (new)
- 1/2" drywall (new)

Note:
If a 3-piece bathroom and bar sink/kitchen are proposed, an additional residential dwelling unit application is required. (Contact Building Services for additional information)

- General Notes:**
1. Drawing is for sample purposes and shall not be used for construction.
 2. Do not submit this drawing as part of your permit application.
 3. Plans shall be drawn to a recognizable scale. (e.g. 1/8" = 1'-0")

- Legend:**
- ☉ Smoke alarm (with strobe)
 - ☉ CO Carbon monoxide alarm (with strobe)
 - ☉ Min. 50cfm exhaust fan (vented to exterior)



Project Name
Sample Drawings

Drawing Title
Basement Floor Plan

Scale
1/8" = 1'-0"
Date
2025
Project
Sample

Drawing Number
A1

Egress Window Details

(not for additional dwelling units)

Image 1: Window size for window serving floor level containing bedrooms (9.9.10.1)

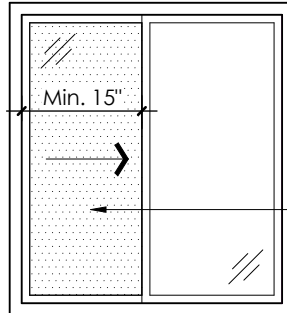

Minimum area of unobstructed opening not less than 0.35m² (3.8ft²) with no dimension less than 380mm (15") when in open position.

Window Requirements:

- Shall be a single motion window (ie.: slider or casement type).
- Shall be openable from the inside without the use of tools or special knowledge.

Image 2: Window well for window serving floor level containing bedrooms (9.9.10.1)

In-swing or slider style

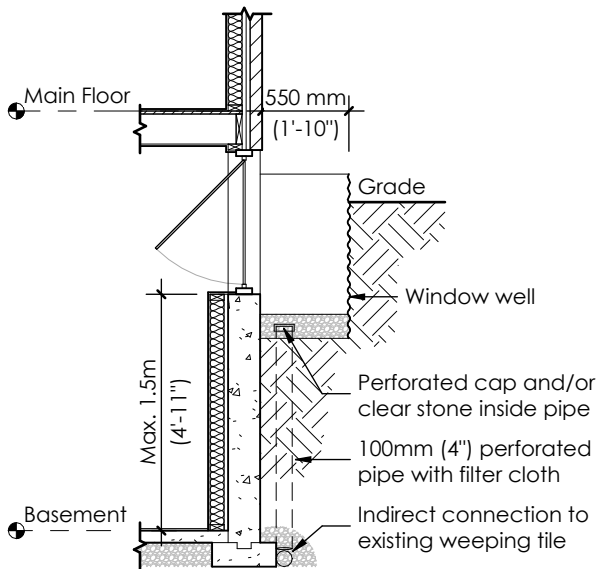

Out-swing style

