

NO.	DATE	DESCRIPTION
1	2025-09-11	ISSUED FOR T&A

## ISSUE RECORD

THE CONTRACTOR SHALL VERIFY AND BE RESPONSIBLE FOR ALL DIMENSIONS AND CONDITIONS ON THE JOB SITE AND SHALL INFORM THE ARCHITECTS IMMEDIATELY OF ANY DISCREPANCY OR VARIATION FROM THE DRAWINGS. DO NOT SCALE THE DRAWINGS.

DRAWINGS ARE NOT TO BE USED FOR CONSTRUCTION UNTIL SIGNED BY THE ARCHITECT.

ALL DRAWINGS, SPECIFICATIONS AND RELATED DOCUMENTS ARE THE COPYRIGHT PROPERTY OF THE ARCHITECT AND MUST BE RETURNED UPON REQUEST. REPRODUCTION OF DRAWINGS, SPECIFICATIONS AND RELATED DOCUMENTS IN PART OR IN WHOLE IS FORBIDDEN WITHOUT WRITTEN PERMISSION.

**windmill**

30 Sudbury St  
Toronto, Ontario M6J 1G5  
T 416 929 5254

**dtah**

425 Adelaide St W  
Suite 600  
Toronto, Ontario  
M5V 3C1  
T 416 598 7908  
F 416 968 0887  
www.dtah.com

DTAH Architects Limited

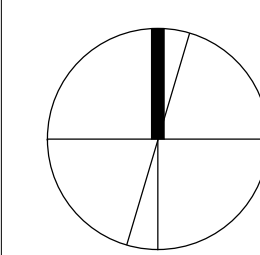
**NOT FOR  
CONSTRUCTION****BAKER DISTRICT  
REDEVELOPMENT****55 BAKER STREET**

PART BURVING GROUND, PLAN 8; PART LANE THROUGH BURVING GROUND, PLAN 8; CLOSED BY MS80255, AS IN MS78644, MS20082, CS58221; S/T INTEREST IF ANY, IN CS58221; PART BURVING GROUND, PLAN 8 AS IN CS51882; CITY OF GUELPH

**160 WYNDHAM STREET NORTH &  
152 WYNDHAM STREET NORTH**

PART LOTS 73 AND 74, PART OF BURVING GROUND AND PART OF JUNE AT THE REAR OF LOTS 73 AND 74 (AKA PARKLANE), CLOSED BY CS51228, REGISTERED PLAN 8, DESIGNATED AS PARTS 1, 2, 3 AND 4, REFERENCE PLAN 61R-21815, SUBJECT TO EASEMENT OVER PART 2, 61R-21815 AS IN INSTRUMENT ROSS57919 AND SUBJECT TO EASEMENT OVER PART 3, 61R-21815 AS IN INSTRUMENT ROSS75090; CITY OF GUELPH

DRAWING TITLE:  
**SITE PLAN**

PRINT DATE: 2025-09-11

SCALE: 1 : 200

PROJECT NO. 24-016

DRAWN BY: SG

CHECKED BY: MT

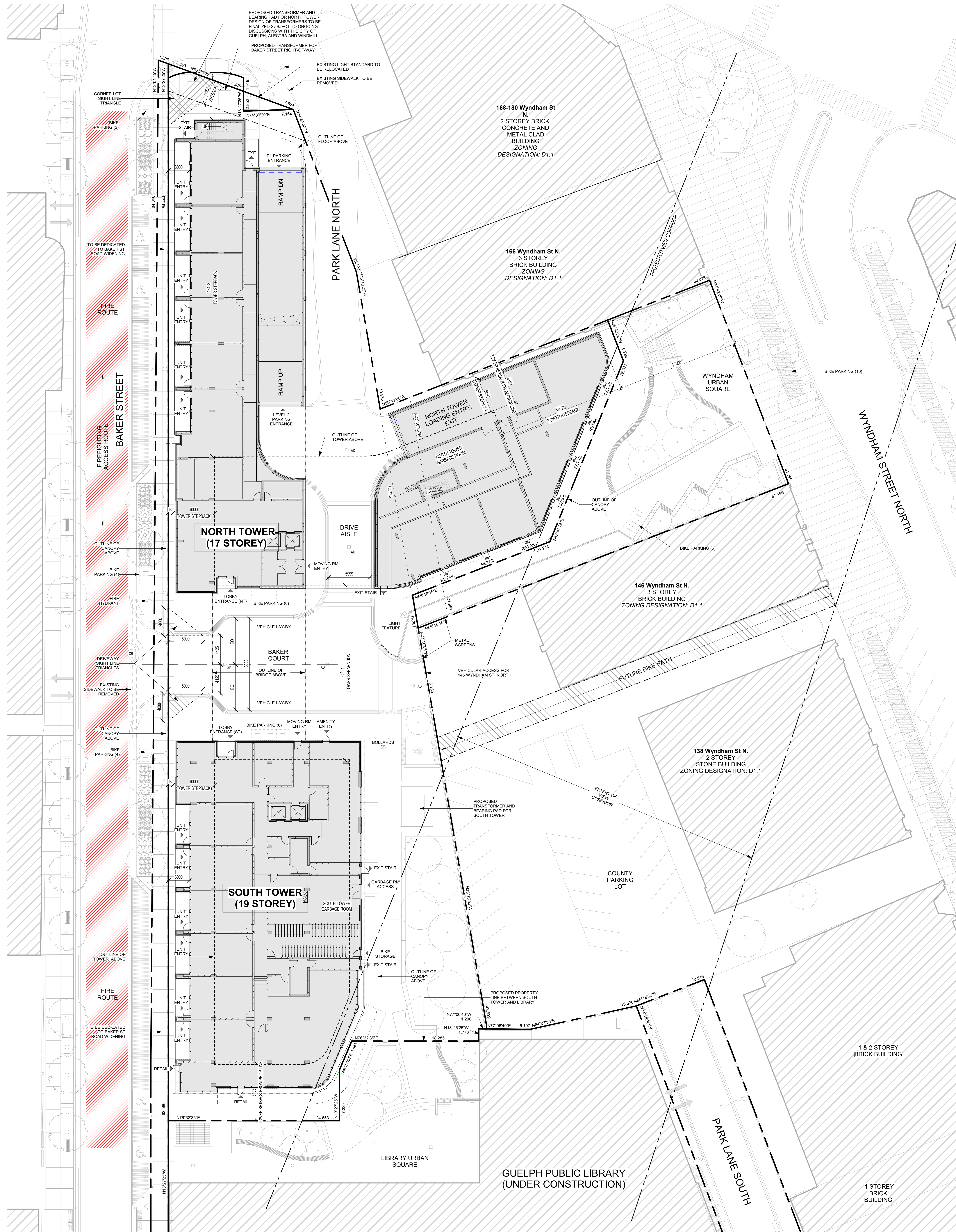
**A100**

1 SITE PLAN  
A100 1:200