

PROPOSED ZONING

HANLON EXPRESSWAY

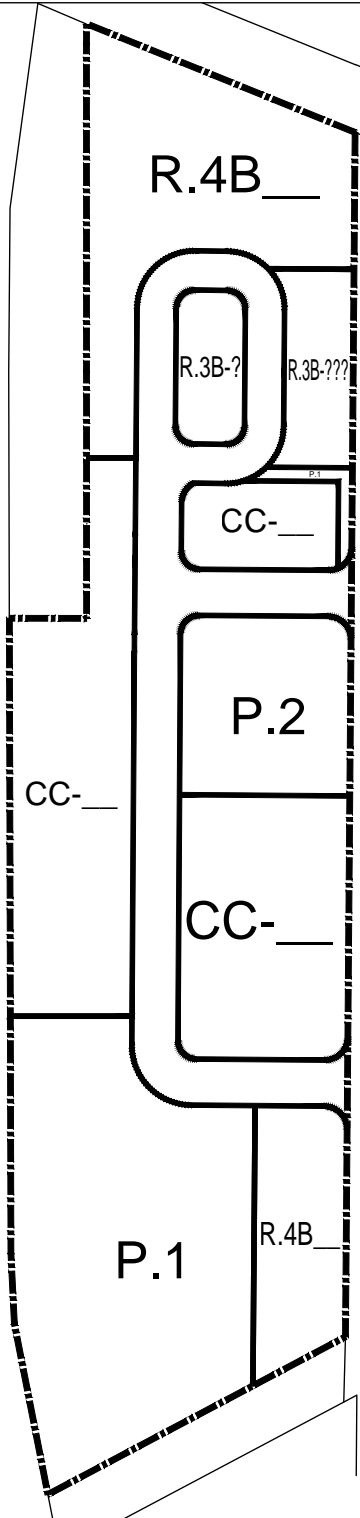

SLIVERCREEK PARKWAY SOUTH

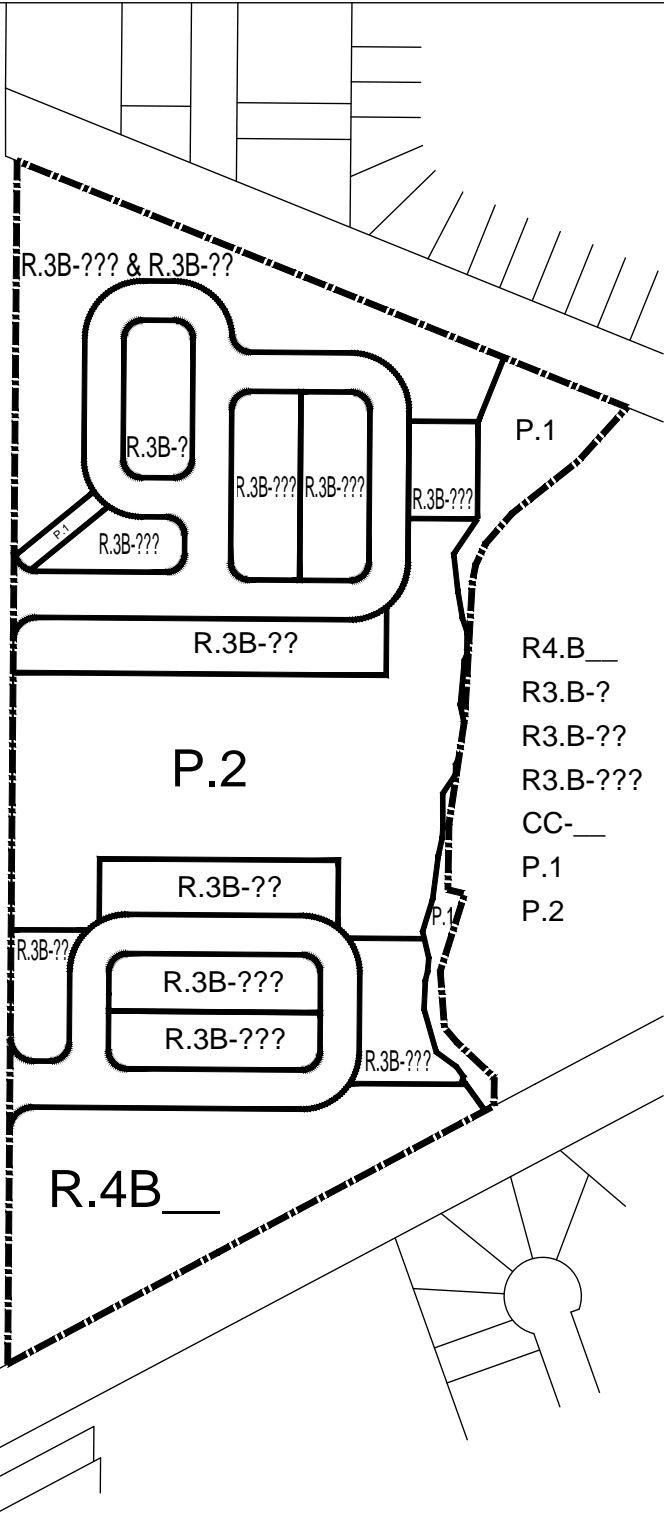

- R.4.B\_\_ SPECIALIZED HIGH DENSITY APARTMENT ZONE
- R.3.B-? SPECIALIZED BACK TO BACK TOWNHOUSE ZONE
- R.3.B-?? SPECIALIZED THROUGH TOWNHOUSE ZONE
- R.3.B-??? SPECIALIZED CONVENTIONAL TOWNHOUSE ZONE
- CC-\_\_ SPECIALIZED COMMUNITY SHOPPING CENTRE ZONE
- P.1 CONSERVATION LAND ZONE
- P.2 NEIGHBOURHOOD PARK ZONE