

KEY PLAN
SCALE: N.T.S.

LEGEND:

- SITE PROPERTY LINE
- - - SWALE
- EXISTING ELEVATIONS TO MATCH
- x 706.53 FINISHED GROUND ELEVATION
- 2.19% PROPOSED SLOPES
- - - STORM CONNECTION
- - - SANITARY CONNECTION
- WATERMAIN CONNECTION

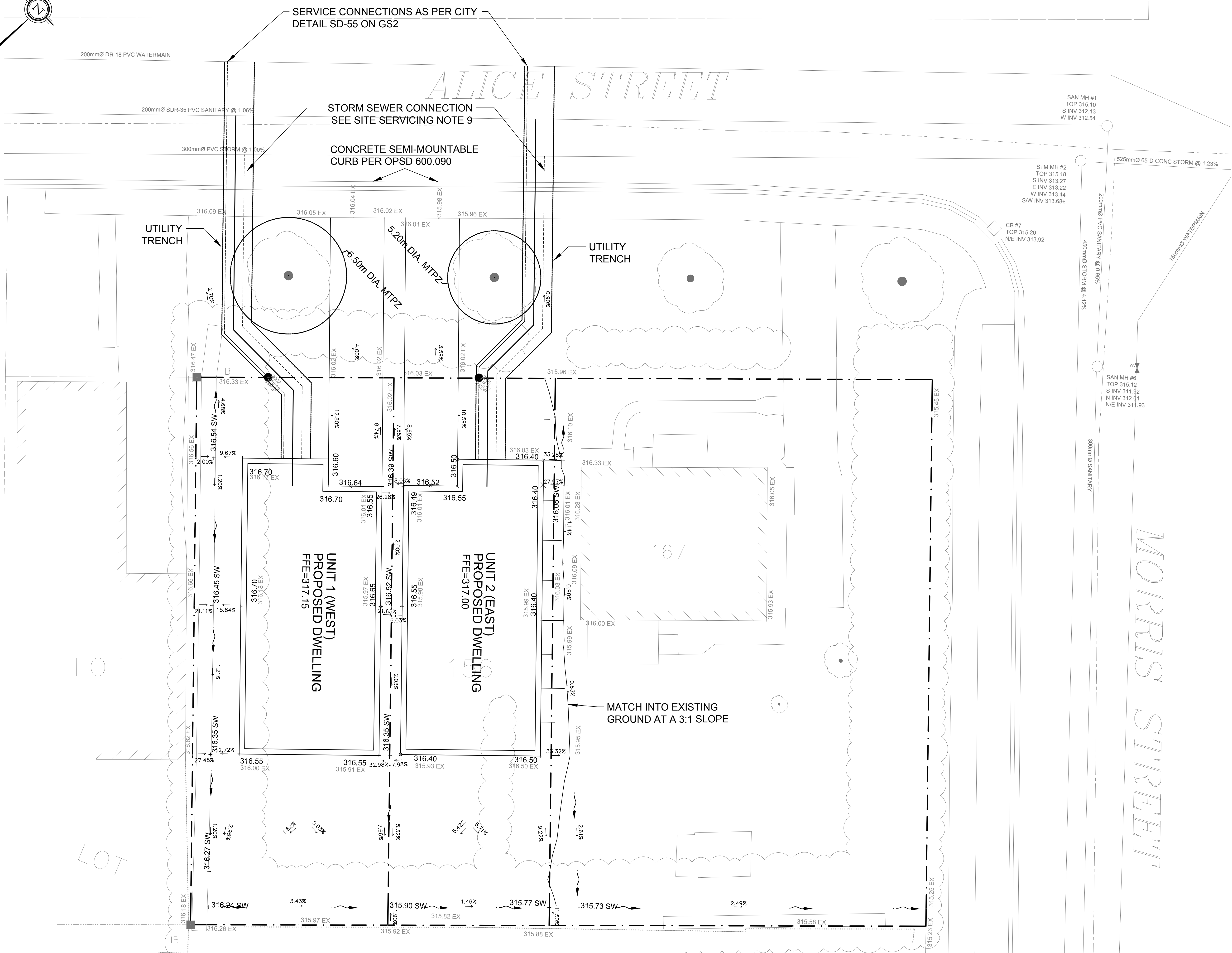

- Notes
1. This drawing is the exclusive property of R. J. Burnside & Associates Limited. The reproduction of any part without prior written consent of this office is strictly prohibited.
 2. The contractor shall verify all dimensions, levels, and datum on site and report any discrepancies or omissions to this office prior to construction.
 3. This drawing is to be read and understood in conjunction with all other plans and documents applicable to this project.

NOT FOR CONSTRUCTION

No.	Issue / Revision	Date	Auth.
1	ISSUED FOR REVIEW	Dec-17	TE
2	UPDATED DRIVEWAY LOCATION	Jan-18	TE
3	UPDATED SERVICE TRENCH	Feb-18	TE

BURNSIDE
R.J. Burnside & Associates Limited
202 Speedvale Ave. W., Unit 20
Guelph, Ontario, N1H 1C4
Telephone: (519) 823-4995
Fax: (519) 836-5477
web: www.rjburnside.com

Client
BLACK, SHOEMAKER, ROBINSON & DONALDSON LTD.
351 SPEEDVALE AVE W
GUELPH, ONTARIO
N1H 1C6

Drawing Title
167 ALICE ST
GUELPH, ONTARIO

GRADING AND SERVICING PLAN

Drawn	Checked	Designed	Checked	Date	Drawing No.
AF	TE	AF	TE	DEC 2017	
Project No.	Contract No.	Revision No.			
300041352					

Scale: 1:100
0 2.0 4.0 6.0m
GS1

- SEE DRAWING GS2 FOR GRADING AND SERVICING NOTES.
- MTPZ (MINIMUM TREE PROTECTION ZONE) BASED ON SURVEY CALIPER OF TREES THAT REPRESENTS CRITICAL ROOT ZONE.