

FILE NAME:

No.	REVISIONS	DATE (MM/DD/YY)	BY
-----	-----------	-----------------	----

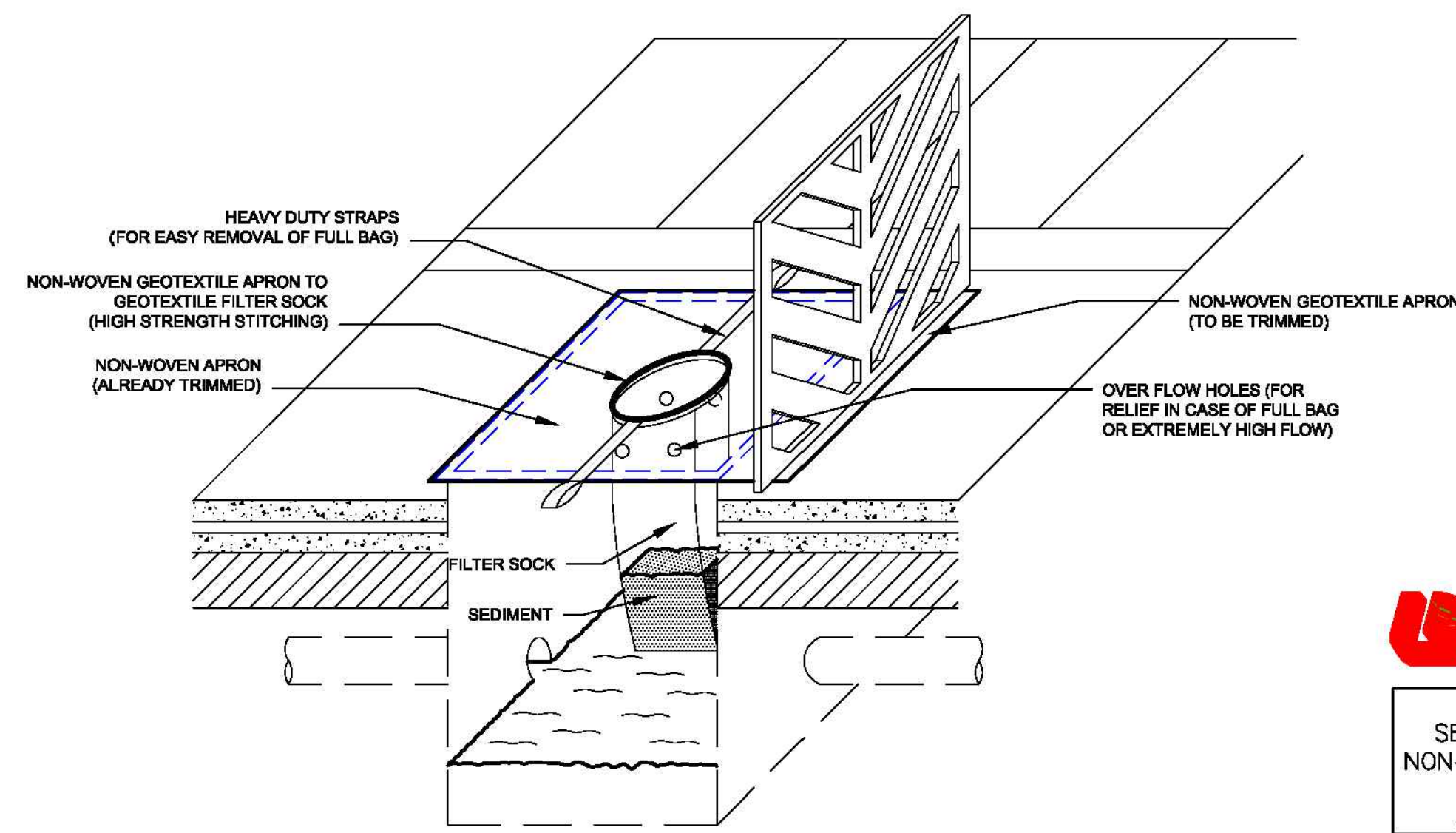

CATCH BASIN  
SEDIMENT TRAP Ø9"  
NON-WOVEN GEOTEXTILE  
LAYFIELD GIF  
ALBERTA, CANADA

Quote No. Project No.

DWG: 1 OF 1 SCALE: 1:25

DWN: AP CWD: APP: P:

DATE: 12/10/07 REVISION: -

LETTER-HORIZONTAL

ITEM	PART NAME	DESCRIPTION
1	CATCH BASIN SEDIMENT TRAP	APRON 36"x39" FILTER SOCK Ø9"x38" LONG

ANSI A Size Page (Horizontal)

DIMENSIONS, MATERIALS AND NOTES ARE FOR REFERENCE ONLY. DESIGNER SHALL MODIFY DETAILS AS PER PARTICULAR PROJECT REQUIREMENTS.

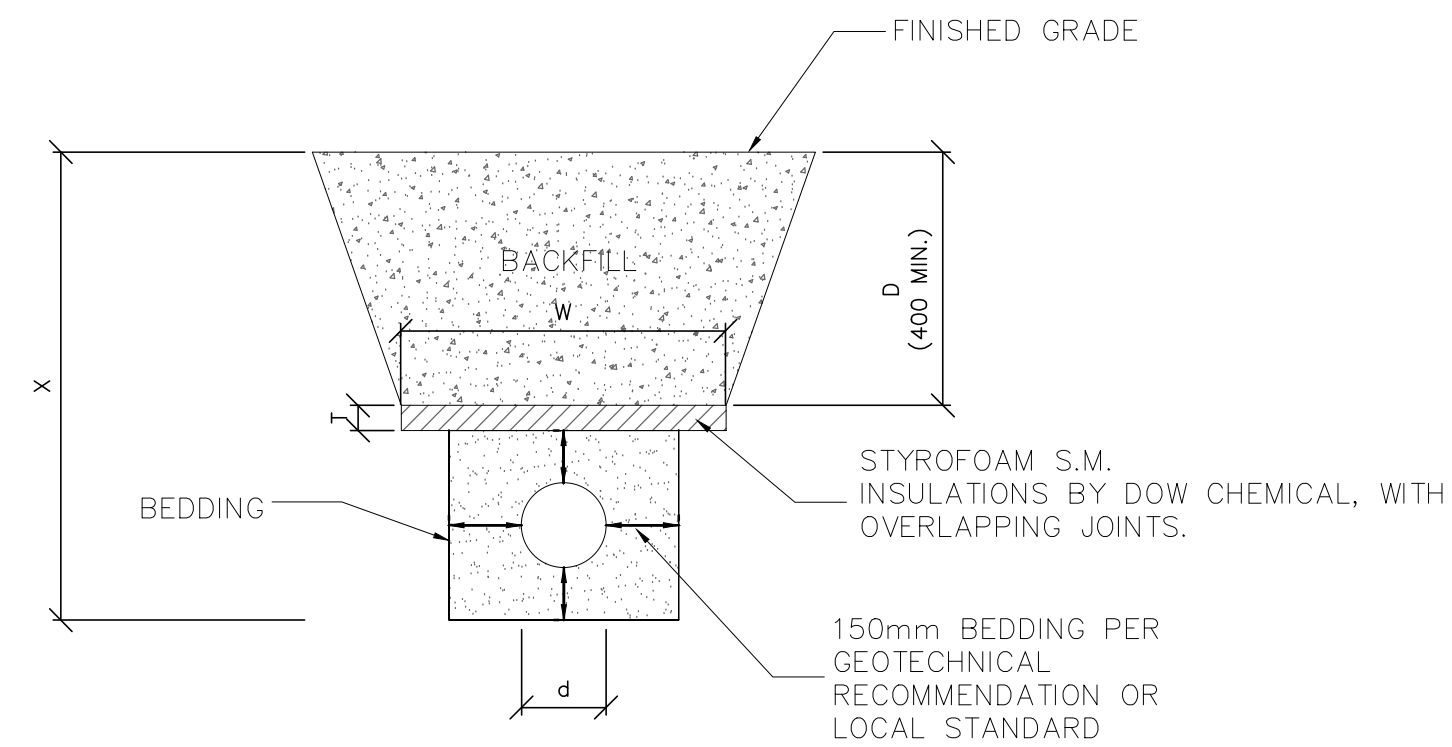

X= FROST PENETRATION DEPTH (x.xx m)  
W= WIDTH OF SLAB IN METRES = 2(X-D)+d  
D= DEPTH OF COVER  
d= OUTSIDE PIPE DIAMETER  
T= INSULATION THICKNESS  
(25mm PER EVERY 0.3m ABOVE FROST DEPTH)

PIPE INSULATION DETAIL

NOTES:  
1. ALL DIMENSIONS ARE IN MILLIMETERS.

JAN 2016	REV	1	DT-702-C
SCALE	N.T.S		

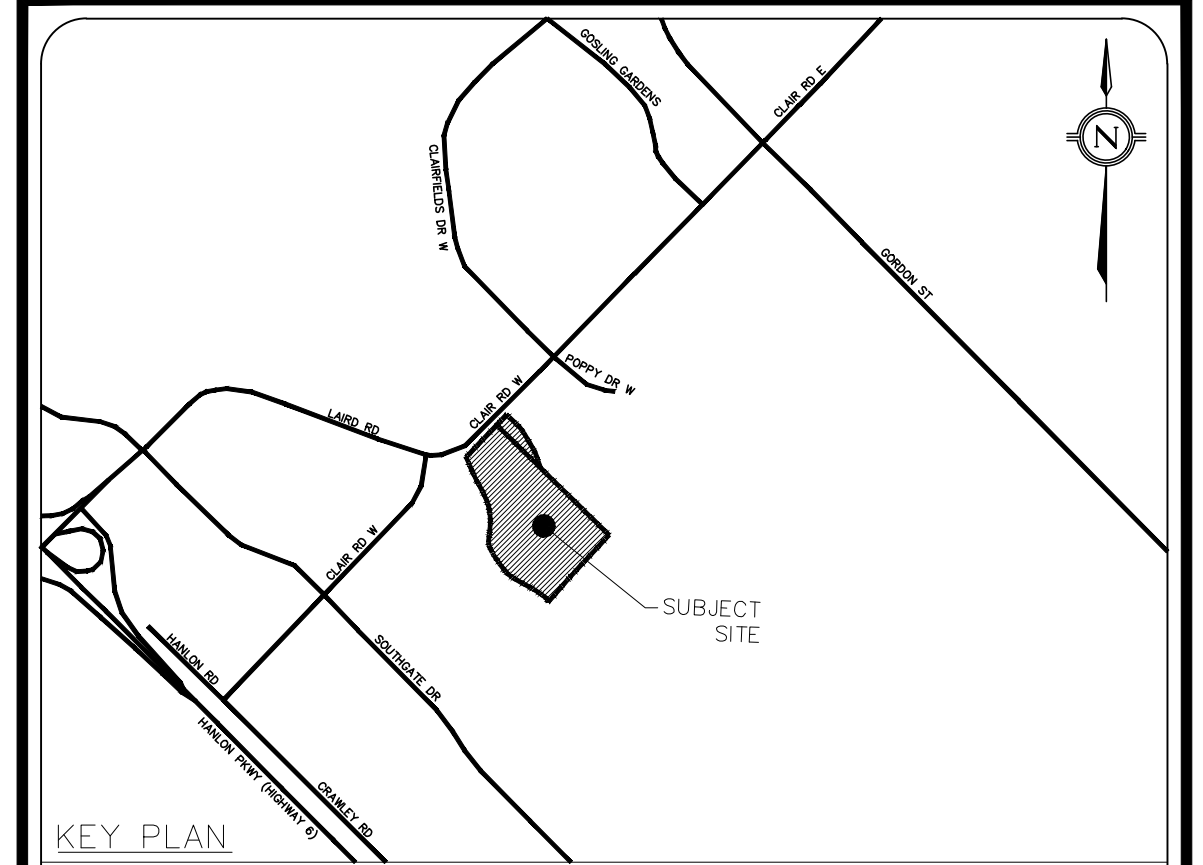

LEGEND

LEGAL & TOPOGRAPHY

PROVIDED BY: J.D. BARNES LIMITED  
257 WOODLAWN ROAD WEST, UNIT 101  
GUELPH, ON N1H 8J1  
PHONE: (519) 822-4031

BENCHMARK AND ELEVATION

ELEVATIONS SHOWN HEREON ARE GEODETIC (CGVD28-1978) AND ARE DERIVED FROM GNSS OBSERVATIONS USING NATURAL RESOURCES CANADA'S GEOD MODEL HTV2.0

BEARINGS ARE UTM GRID, DERIVED FROM OBSERVED REFERENCE POINTS A AND B, BY REAL TIME NETWORK (RTN) OBSERVATIONS, UTM ZONE 17, NAD83 (CSRS) (2010.0).

No.	ISSUED FOR REZONING #1 (30%) REVISIONS/ISSUED	DATE	BY	CITY
1		20/11/2024		

counterpoint ENGINEERING  
A SUBSIDIARY OF DILLON CONSULTING LIMITED  
8395 Jane St., Suite 100, Vaughan, ON L4K 5Y2 Phone 905.326.1404 Fax 905.326.1405



APPLICANT:  
HOME OPPORTUNITIES  
478 QUEEN STREET EAST, SUITE 201  
TORONTO, ON M5A 1T7  
PHONE: (416) 504-9855

SITE LOCATION:  
280 CLAIR ROAD WEST  
GUELPH, ON N1L 1G1

SITE PLAN FILE No.:

DETAILS

DESIGNED BY: J.Y.	CHECKED BY: J.H.	DATE: SEPTEMBER, 2024
DRAWING BY: G.D.	CHECKED BY: J.H.	PROJECT NO. 24010
SCALE: N.T.S	CHECKED BY: J.H.	DRAWING NO. SW-D2