

This drawing is the property of the Architect and may not be reproduced or used without the express consent of the Architect. The Contractor is responsible for checking and verifying all levels and dimensions and shall report all discrepancies to the Architect and obtain clarification prior to commencing work.

ISSUED RECORD REZONING

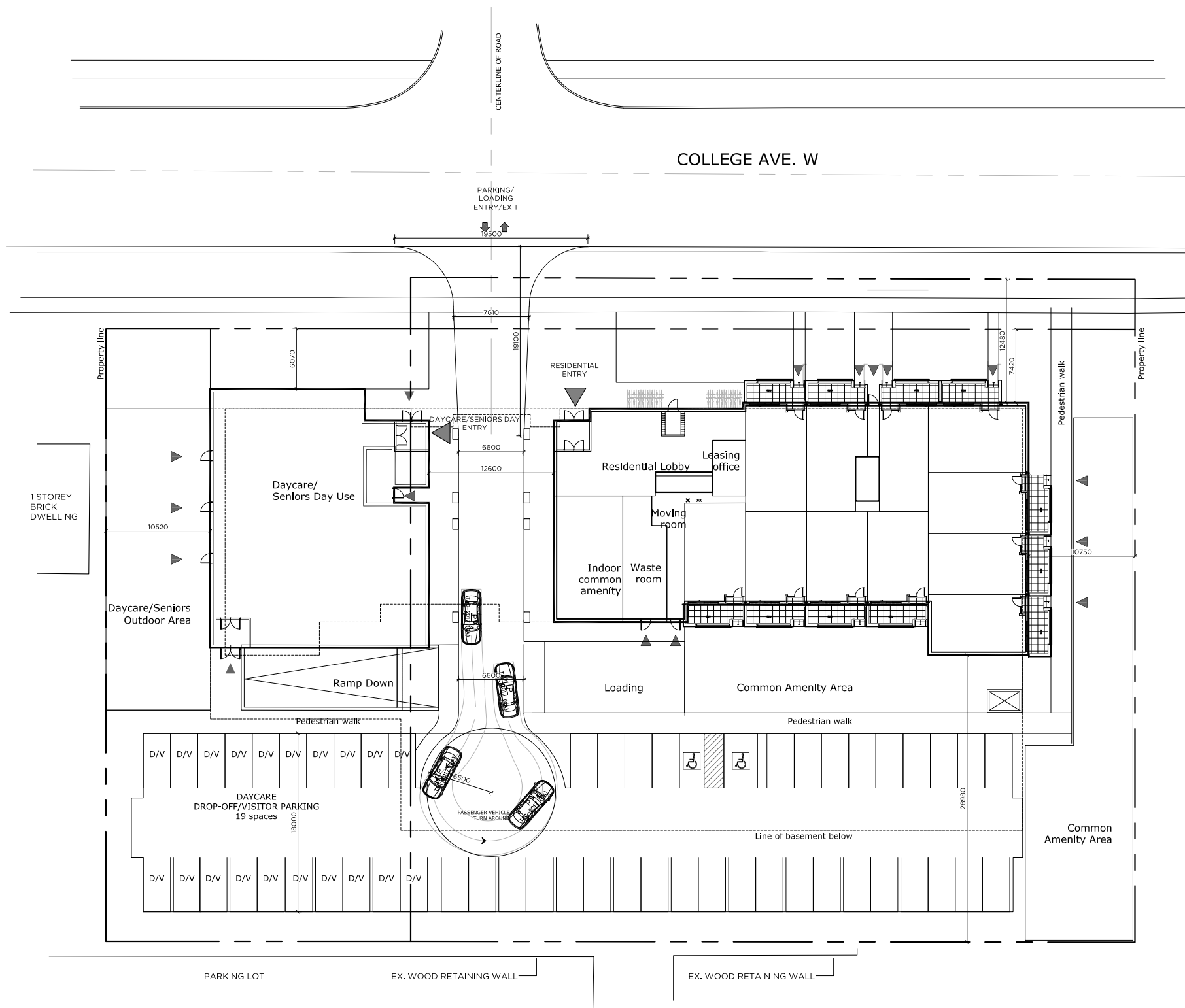

Zone: Specialized High Density Apartment Zone (R.4B - XX)		
	Required	Provided
Minimum Lot Area	650 m2	6434 m2
Minimum Lot Frontage	15 m	103.9 m
Minimum Lot Depth		61.9m
Number of Units	-	110
Maximum Density units/ha	150	171
Min. Front Yard Setback	6 metres	6 m
Max. Front Yard Setback	-	8.7 m
Minimum Exterior Side Yard	6 metres	-
Minimum Side Yard	10.5	10.75m E / 10.5 m W
Min. Rear Yard	12.3m	29m
Max. Rear Yard	-	33.3 m
Maximum Building Height	10 storeys	6 storeys 21m
Min. Common Amenity Area	2400 m2	2421 m2
Min. Landscaped Open Space	40%	32%
Off-Street Parking	163	133
Buffer Strip	Yes	Yes
Accessory Bldgs or Structures	N/A	N/A
Garbage, Refuse Storage + Composters	In Bldg or Rear/Side	In Bldg
Floor Space Index	1.5	1.64

REVISION RECORD

NORTH



405-317 ADELAIDE ST. W.
TORONTO CANADA M5V 1P
+1 416 599 9729
WWW.RAWDESIGN.CA

18030

166 College St. W
Guelph

Pinemount

CONCEPTUAL
SITE PLAN
STATS

1:500

A100