

- NOTES :**
1. TOPOGRAPHICAL PLAN OF SURVEY PREPARED BY VAN HARTEN SURVEYING INC. DATED 2021-02-21.
 2. PROPOSED SITE PLAN PREPARED BY BROADVIEW ARCHITECT INC. DATED 2023-03-01.
 3. MUNICIPAL SANITARY AND STORM SERVICING ALONG LANDSDOWN DRIVE SURVEYED BY GM BLUEPLAN ENGINEERING LTD. DATED 2021-12-14.
 4. MUNICIPAL WATERMAIN AND LOT SERVICES ALONG LANDSDOWN DRIVE OBTAINED FROM CITY OF GUELPH PLAN AND PROFILE AS RECORDED DRAWINGS 1-319 AND 1-320, DATED FEBRUARY 2008.
 5. MUNICIPAL SERVICING AND CONC. ENCASED BELL CONDUIT ALONG GORDON STREET OBTAINED FROM CITY OF GUELPH PLAN AND PROFILE AS RECORDED DRAWINGS 2D-102 AND 2D-103, DATED FEBRUARY 2008.
 6. APPROXIMATE LOCATION OF EXISTING GAS AS PER DRAWING PROVIDED BY ENBRIDGE GAS, DATED 2021-11-10.
 7. APPROXIMATE LOCATION OF EXISTING BELLS AS PER DRAWING PROVIDED BY BELL CANADA, DATED 2021-11-27.
 8. APPROXIMATE LOCATION OF EXISTING ROGERS AS PER DRAWING PROVIDED BY ROGERS COMMUNICATION, DATED 2021-11-30.
 9. FOR TOWNHOUSE BLOCK #1 TO #3, CANADA POST TO ADD AN ADDITIONAL MODULE TO EXISTING COMMUNITY MAILBOX ACROSS FROM HOUSE #34 LANDSDOWN DRIVE.

BENCH MARKS :
REFER TO VAN HARTEN SURVEYING INC., PROJECT #27080-19 FOR BENCHMARK INFORMATION.

THE POSITION OF POLE LINES, CONDUITS, WATERMANS, SEWERS AND OTHER UNDERGROUND AND OVERGROUND UTILITIES AND STRUCTURES IS NOT NECESSARILY SHOWN ON THE CONTRACT DRAWINGS AND, WHERE SHOWN, THE ACCURACY OF THE POSITION OF SUCH UTILITIES AND STRUCTURES IS NOT GUARANTEED.

BEFORE STARTING WORK, THE CONTRACTOR SHALL INFORM HIMSELF OF THE EXACT LOCATION OF ALL SUCH UTILITIES AND STRUCTURES, AND SHALL ASSUME ALL LIABILITY FOR ANY DAMAGE TO THEM.

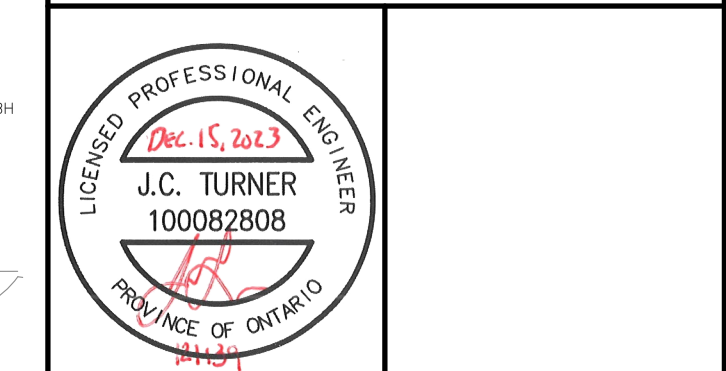

NO.	DATE	REVISION DESCRIPTION	CHKD
3	2023-12-18	REVISED PER CITY COMMENT	J.T.
2	2023-04-20	REVISED PER CITY COMMENT	J.T.
1	2022-03-11	ISSUED FOR ZONING BY-LAW AMENDMENT	J.T.

GUELPH | OWEN SOUND | LISTOWEL | KITCHENER | LONDON | HAMILTON | GTA
650 WOODLAWN ROAD WEST, BLOCK C, UNIT 2, GUELPH, ON N1K 1S8
TEL 519-824-8100 www.blueplan.ca

1166 - 1204 GORDON STREET

RESIDENTIAL DEVELOPMENT

CITY OF GUELPH

EXISTING CONDITIONS

DRAWN BY:	APPROVED BY:	PROJECT NO.:	DRAWING NO.:
B.L.	J.T.	121139	EX
DESIGNED BY:	DATE:	SCALE:	
J.T.	DEC, 2021	1:250	

- LEGEND**
- PROPERTY LINE
 - EX. SANITARY SEWER
 - EX. STORM SEWER
 - EX. WATERMAIN
 - EX. BELL LINE
 - EX. GAS LINE
 - EX. ROGERS LINE
 - EX. FENCE LINE
 - EX. CONTOURS
 - EX. CATCH BASIN
 - EX. WATER VALVE
 - EX. FIRE HYDRANT
 - EX. LIGHT STANDARD
 - HEDGE
 - CONIFEROUS/DECIDUOUS TREES

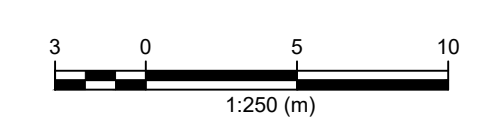

FILE: W:\Guelph\20211118_1166-1204 Gordon St\2023\1166-1204 Gordon St\2023\1166-1204 Gordon St\1166-1204 Gordon St\1166-1204 Gordon St.dwg
 PLOT: 1166-1204 Gordon St.dwg
 PLOT DATE: 2023-12-18 10:00:00
 PLOT USER: J.T.

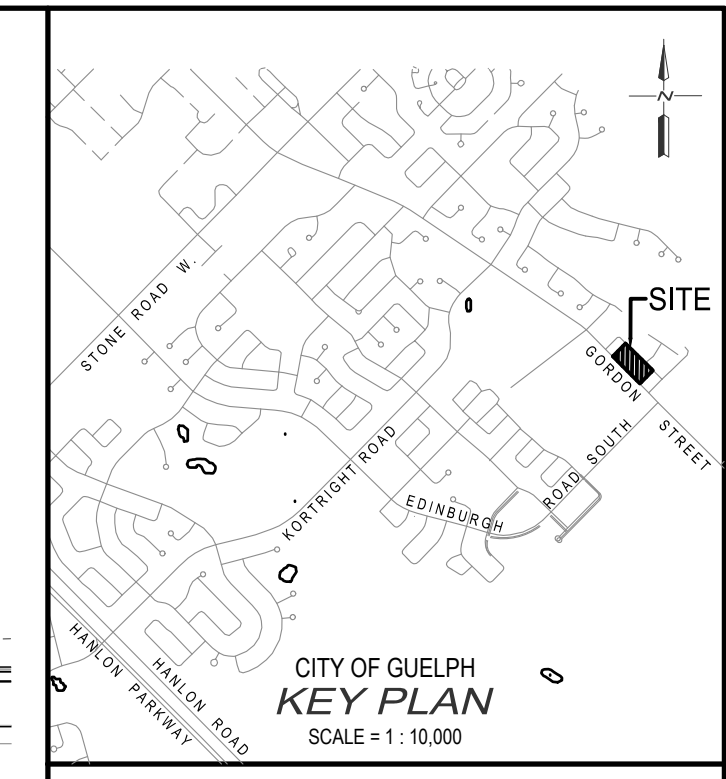
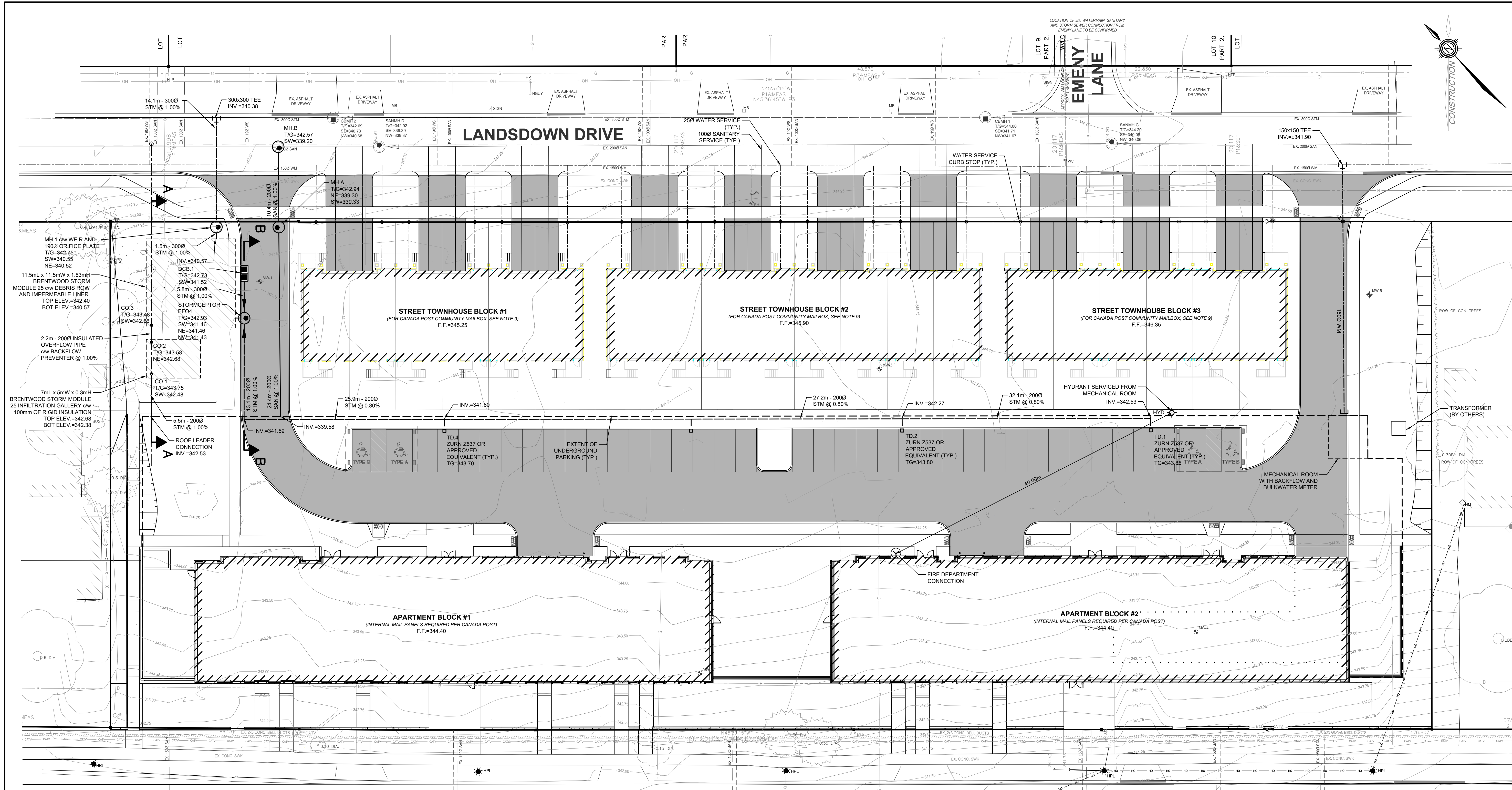

- NOTES:**
1. TOPOGRAPHICAL PLAN OF SURVEY PREPARED BY VAN HARTEN SURVEYING INC., DATED 2021-02-21.
 2. PROPOSED SITE PLAN PREPARED BY BROADVIEW ARCHITECT INC., DATED 2023-10-31.
 3. MUNICIPAL SANITARY AND STORM SERVICE ALONG LANDSDOWN DRIVE SURVEYED BY GM BLUEPLAN ENGINEERING LTD., DATED 2021-12-14.
 4. MUNICIPAL WATERMAIN AND LOT SERVICES ALONG LANDSDOWN DRIVE OBTAINED FROM CITY OF GUELPH PLAN AND PROFILE AS RECORDED DRAWINGS 1319 AND 1320, DATED FEBRUARY 2008.
 5. MUNICIPAL SERVING AND CONC. ENCASED BELL CONDUIT ALONG GORDON STREET OBTAINED FROM CITY OF GUELPH PLAN AND PROFILE AS RECORDED DRAWINGS 2D-102 AND 2D-103, DATED FEBRUARY 2008.
 6. APPROXIMATE LOCATION OF EXISTING GAS AS PER DRAWING PROVIDED BY ENBRIDGE GAS, DATED 2021-11-10.
 7. APPROXIMATE LOCATION OF EXISTING BELL AS PER DRAWING PROVIDED BY BELL CANADA, DATED 2021-11-27.
 8. APPROXIMATE LOCATION OF EXISTING ROGERS AS PER DRAWING PROVIDED BY ROGERS COMMUNICATION, DATED 2021-11-30.
 9. FOR TOWNHOUSE BLOCK #1 TO #3, CANADA POST TO ADD AN ADDITIONAL MODULE TO EXISTING COMMUNITY MAILBOX ACROSS FROM HOUSE #34 LANDSDOWN DRIVE.

BENCH MARKS:
REFER TO VAN HARTEN SURVEYING INC., PROJECT #27080-19 FOR BENCHMARK INFORMATION.

THE POSITION OF POLE LINES, CONDUITS, WATERMANS, SEWERS AND OTHER UNDERGROUND AND OVERGROUND UTILITIES AND STRUCTURES IS NOT NECESSARILY SHOWN ON THE CONTRACT DRAWINGS AND, WHERE SHOWN, THE ACCURACY OF THE POSITION OF SUCH UTILITIES AND STRUCTURES IS NOT GUARANTEED.

BEFORE STARTING WORK, THE CONTRACTOR SHALL INFORM HIMSELF OF THE EXACT LOCATION OF ALL SUCH UTILITIES AND STRUCTURES, AND SHALL ASSUME ALL LIABILITY FOR ANY DAMAGE TO THEM.

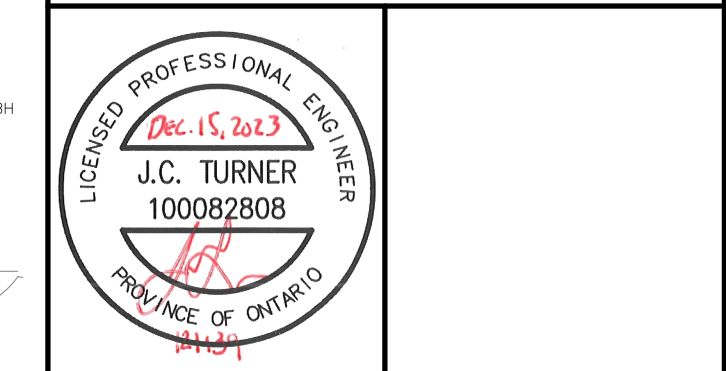

NO.	DATE	REVISION DESCRIPTION	CHKD
3.	2023-12-18	REVISED PER CITY COMMENT	J.T.
2.	2023-04-20	REVISED PER CITY COMMENT	J.T.
1.	2022-03-11	ISSUED FOR ZONING BY-LAW AMENDMENT	J.T.

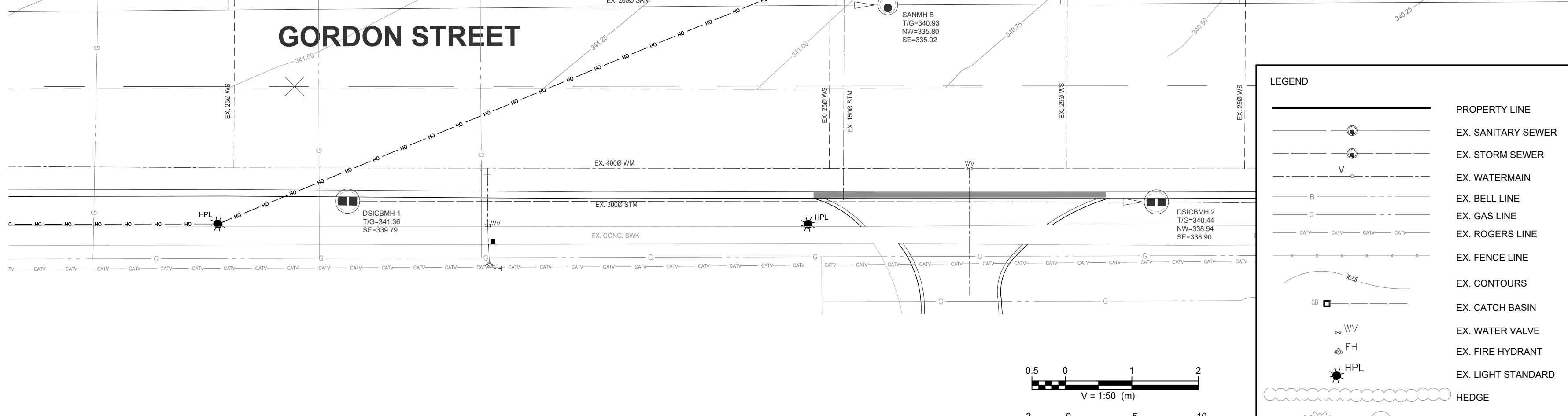
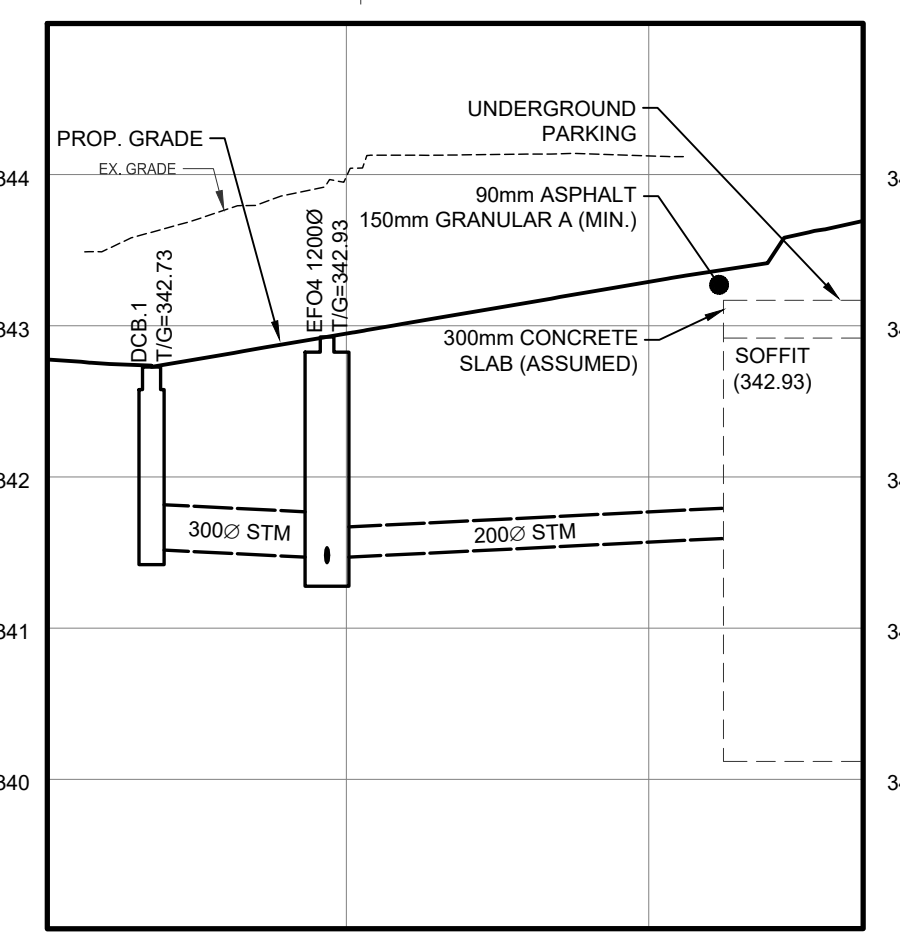
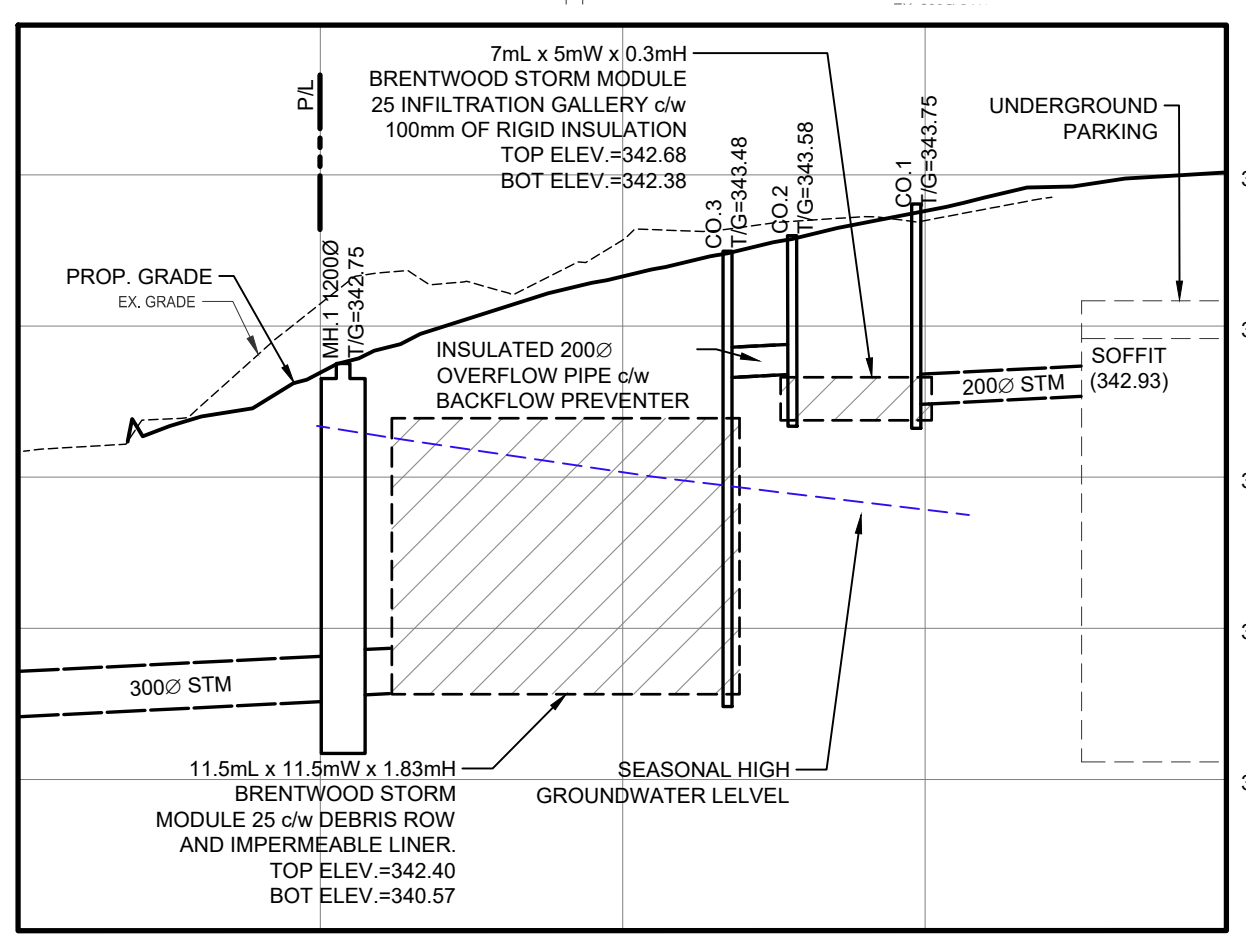

BluePlan ENGINEERING
GUELPH | OWEN SOUND | LESTERDALE | KITCHENER | LONDON | HAMILTON | GTA
650 WOODLAWN ROAD WEST, BLOCK C, UNIT 2, GUELPH, ON, N1K 1S8
TEL: 519-824-8100 www.blueplan.ca

1166 - 1204 GORDON STREET
RESIDENTIAL DEVELOPMENT

CITY OF GUELPH
SITE SERVICING PLAN

DRAWN BY:	APPROVED BY:	PROJECT NO.:	DRAWING NO.:
B.L.	J.T.	121139	SSP
DESIGNED BY:	DATE:	SCALE:	
J.T.	DEC, 2021	1:250	

FILE: W:\Guelph\1204\1204-1139 - 1166-1204 Gordon St Residential Development\121139-SSP.dwg, LAYOUT: SSP.dwg, PLOT DATE: 2023-12-18 10:00:00 AM, PLOT BY: J.T.

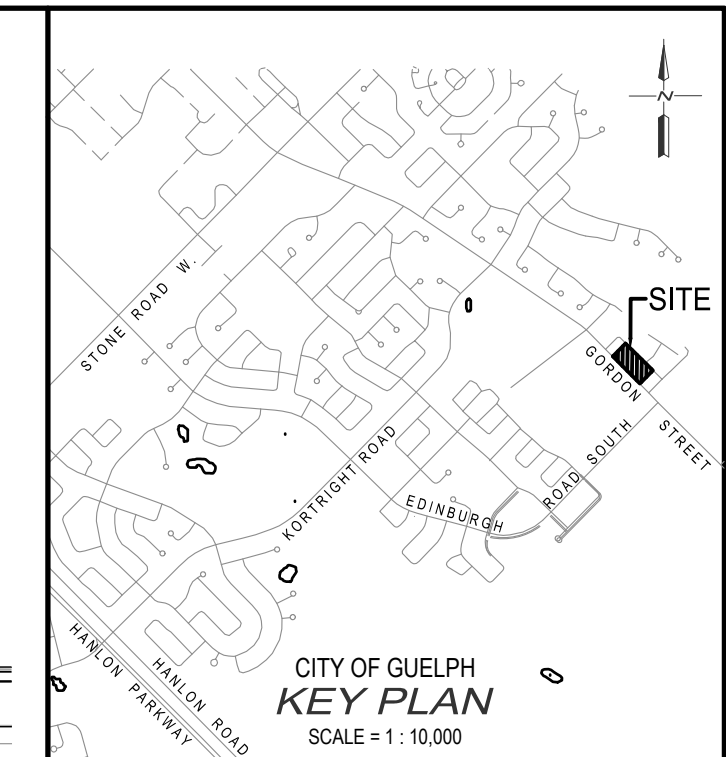
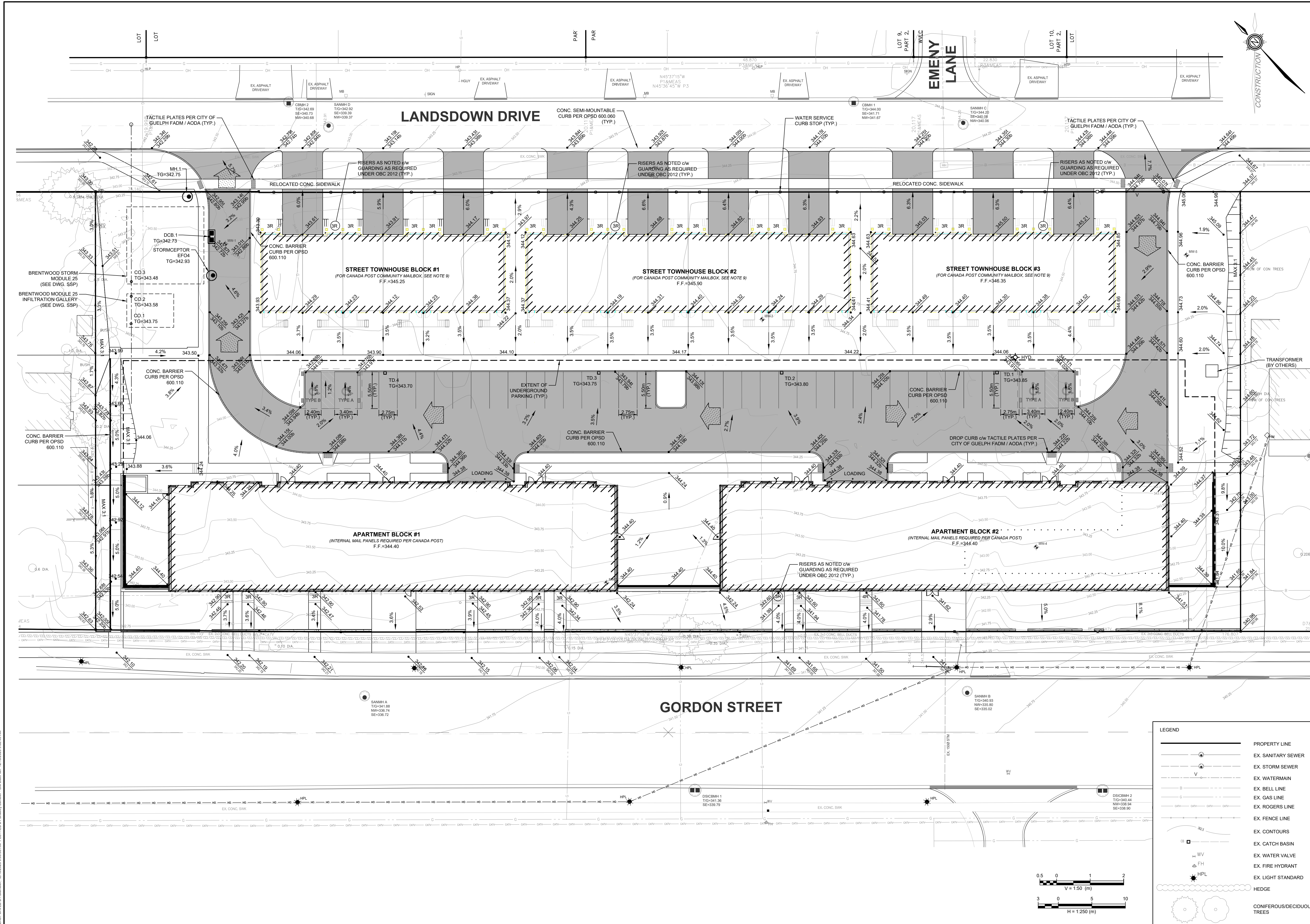

- NOTES:**
1. TOPOGRAPHICAL PLAN OF SURVEY PREPARED BY VAN HARTEN SURVEYING INC., DATED 2021-02-21.
 2. PROPOSED SITE PLAN PREPARED BY BROADVIEW ARCHITECT INC., DATED 2023-10-31.
 3. MUNICIPAL SANITARY AND STORM SERVING ALONG LANDSDOWN DRIVE SURVEYED BY GM BLUEPLAN ENGINEERING LTD., DATED 2021-12-14.
 4. MUNICIPAL WATERMAIN AND LOT SERVICES ALONG LANDSDOWN DRIVE OBTAINED FROM CITY OF GUELPH PLAN AND PROFILE AS RECORDED DRAWINGS 1-319 AND 1-320, DATED FEBRUARY 2008.
 5. MUNICIPAL SERVING AND CONC. ENCASED BELL CONDUIT ALONG GORDON STREET OBTAINED FROM CITY OF GUELPH PLAN AND PROFILE AS RECORDED DRAWINGS 2D-102 AND 2D-103, DATED FEBRUARY 2008.
 6. APPROXIMATE LOCATION OF EXISTING GAS AS PER DRAWING PROVIDED BY ENBRIDGE GAS, DATED 2021-11-10.
 7. APPROXIMATE LOCATION OF EXISTING BELL AS PER DRAWING PROVIDED BY BELL CANADA, DATED 2021-11-27.
 8. APPROXIMATE LOCATION OF EXISTING ROGERS AS PER DRAWING PROVIDED BY ROGERS COMMUNICATION, DATED 2021-11-30.
 9. FOR TOWNHOUSE BLOCK #1 TO #3, CANADA POST TO ADD AN ADDITIONAL MODULE TO EXISTING COMMUNITY MAILBOX ACROSS FROM HOUSE #34 LANDSDOWN DRIVE.

BENCH MARKS:
REFER TO VAN HARTEN SURVEYING INC., PROJECT #27080-19 FOR BENCHMARK INFORMATION.

THE POSITION OF POLE LINES, CONDUITS, WATERMANS, SEWERS AND OTHER UNDERGROUND AND OVERGROUND UTILITIES AND STRUCTURES IS NOT NECESSARILY SHOWN ON THE CONTRACT DRAWINGS, AND, WHERE SHOWN, THE ACCURACY OF THE POSITION OF SUCH UTILITIES AND STRUCTURES IS NOT GUARANTEED.

BEFORE STARTING WORK, THE CONTRACTOR SHALL INFORM HISSELF OF THE EXACT LOCATION OF ALL SUCH UTILITIES AND STRUCTURES, AND SHALL ASSUME ALL LIABILITY FOR ANY DAMAGE TO THEM.

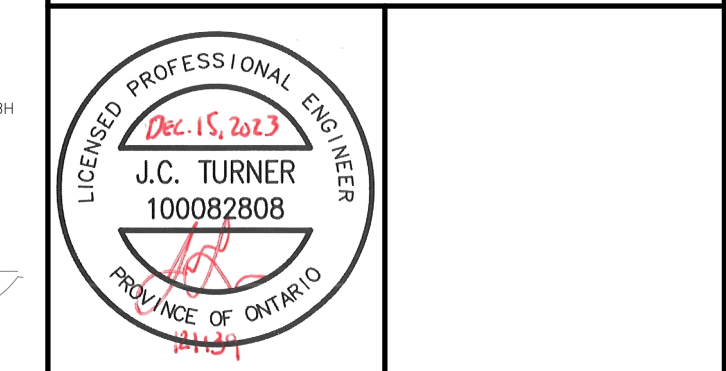

NO.	DATE	REVISION DESCRIPTION	CHKD
3.	2023-12-18	REVISED PER CITY COMMENT	J.T.
2.	2023-04-20	REVISED PER CITY COMMENT	J.T.
1.	2022-03-11	ISSUED FOR ZONING BY-LAW AMENDMENT	J.T.

LEGEND

	PROPERTY LINE
	EX. SANITARY SEWER
	EX. STORM SEWER
	EX. WATERMAIN
	EX. BELL LINE
	EX. GAS LINE
	EX. ROGERS LINE
	EX. FENCE LINE
	EX. CONTOURS
	EX. CATCH BASIN
	EX. WATER VALVE
	EX. FIRE HYDRANT
	EX. LIGHT STANDARD
	HEDGE
	CONIFEROUS/DECIDUOUS TREES

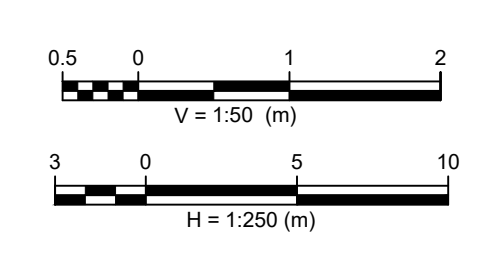

BluePlan ENGINEERING

GUELPH | OWEN SOUND | LISTOWEL | KITCHENER | LONDON | HAMILTON | GTA
650 WOODLAWN ROAD WEST, BLOCK 2, UNIT 2, GUELPH, ON, N1K 1S8
TEL: 519-824-8100 www.blueplan.ca

1166 - 1204 GORDON STREET

RESIDENTIAL DEVELOPMENT

CITY OF GUELPH

SITE GRADING PLAN

DRAWN BY:	APPROVED BY:	PROJECT NO.:	DRAWING NO.:
B.L.	J.T.	121139	
DESIGNED BY:	DATE:	SCALE:	SGP
J.T.	DEC, 2021	1:250	

FILE: W:\Guelph\12-2021\121139 - 1166-1204 Gordon St Residential Development\121139_SGP.dwg, LAYOUT: SGP
 PLOT: 121139_SGP.dwg, 12/18/2023 10:58:11 AM, PLOTTER: HP DesignJet T1100e, PLOT SCALE: 1:250