

EXTERIOR BASEMENT STAIR - REINFORCING DETAIL

BACKFILL HEIGHTS GREATER THAN 1.2m (3'-11"), UP TO 2.15m (7'-0")

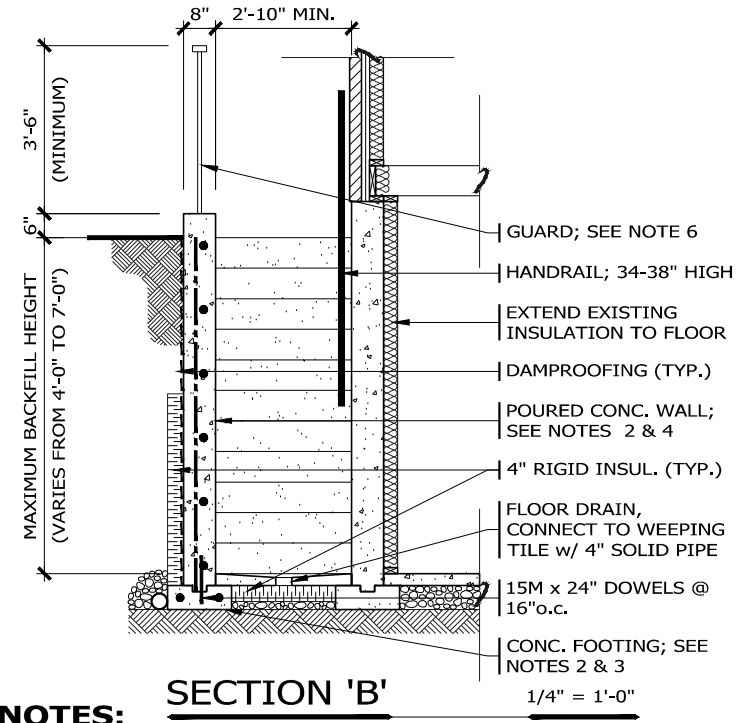
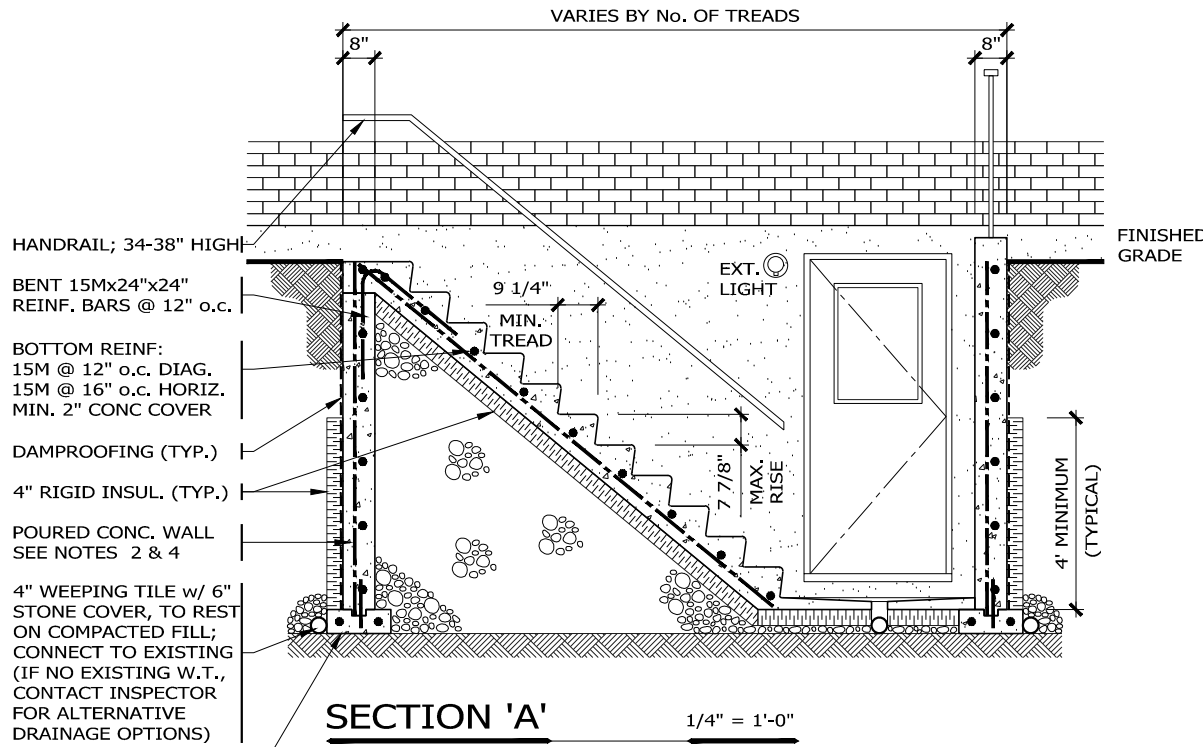

NOTES:

- GENERAL**
 - BACKFILL HEIGHTS OF GREATER THAN 7'-0" REQUIRE A PROF. ENGINEERS DESIGN.
 - POURED CONCRETE WALLS ONLY; NOT CONCRETE BLOCK.
 - POURED CONCRETE OR PRESSURE TREATED WOOD STAIRS.
- CONCRETE**
MINIMUM COMPRESSIVE STRENGTH OF 35 MPa @ 28 DAYS w/ 5% TO 8% AIR ENTRAINMENT.
- FOOTINGS**
16" x 6" POURED CONCRETE FOOTING c/w 2 - 15M BARS. FOOTINGS SHALL REST ON UNDISTURBED SOIL OR COMPACTED GRANULAR FILL.
- RETAINING WALL**
8" POURED CONC. WALL DOES NOT REQUIRE REBAR IF BACKFILL HEIGHT DOES NOT EXCEED 3'-11". PROVIDE 15M REBAR @ 16" o.c. EACH WAY FOR BACKFILL HEIGHTS EXCEEDING 3'-11". AN ENGINEER'S DESIGN IS REQ'D FOR HEIGHTS EXCEEDING 7'-0".
- STAIRS**
RISE - 4 7/8" MIN, 7 7/8" MAX TREAD - 9 1/4" MIN, 14" MAX. NOTE: ALL RISERS & TREADS SHALL BE UNIFORM.
- GUARDS**
GUARDS SHALL BE MIN. 35" HIGH (42" IF > 71" FROM TOP OF STAIRS TO BOTTOM OF STAIRS), SHALL NOT ALLOW THE PASSAGE OF A 4" DIAMETER SPHERE THROUGH OPENINGS, BE DESIGNED TO PREVENT CLIMBING AND DESIGNED TO WITHSTAND THE LOADING IN TABLE 9.8.8.2. PROVIDE GUARD DETAILS TO INSPECTOR ON SITE, PRIOR TO INSTALLATION OF GUARD.
- INSPECTIONS**
AN INSPECTION OF ALL REBAR IS REQ'D PRIOR TO POURING CONC.

