

The Norwich Street Bridge Reconstruction Virtual Open House

July 15, 2020

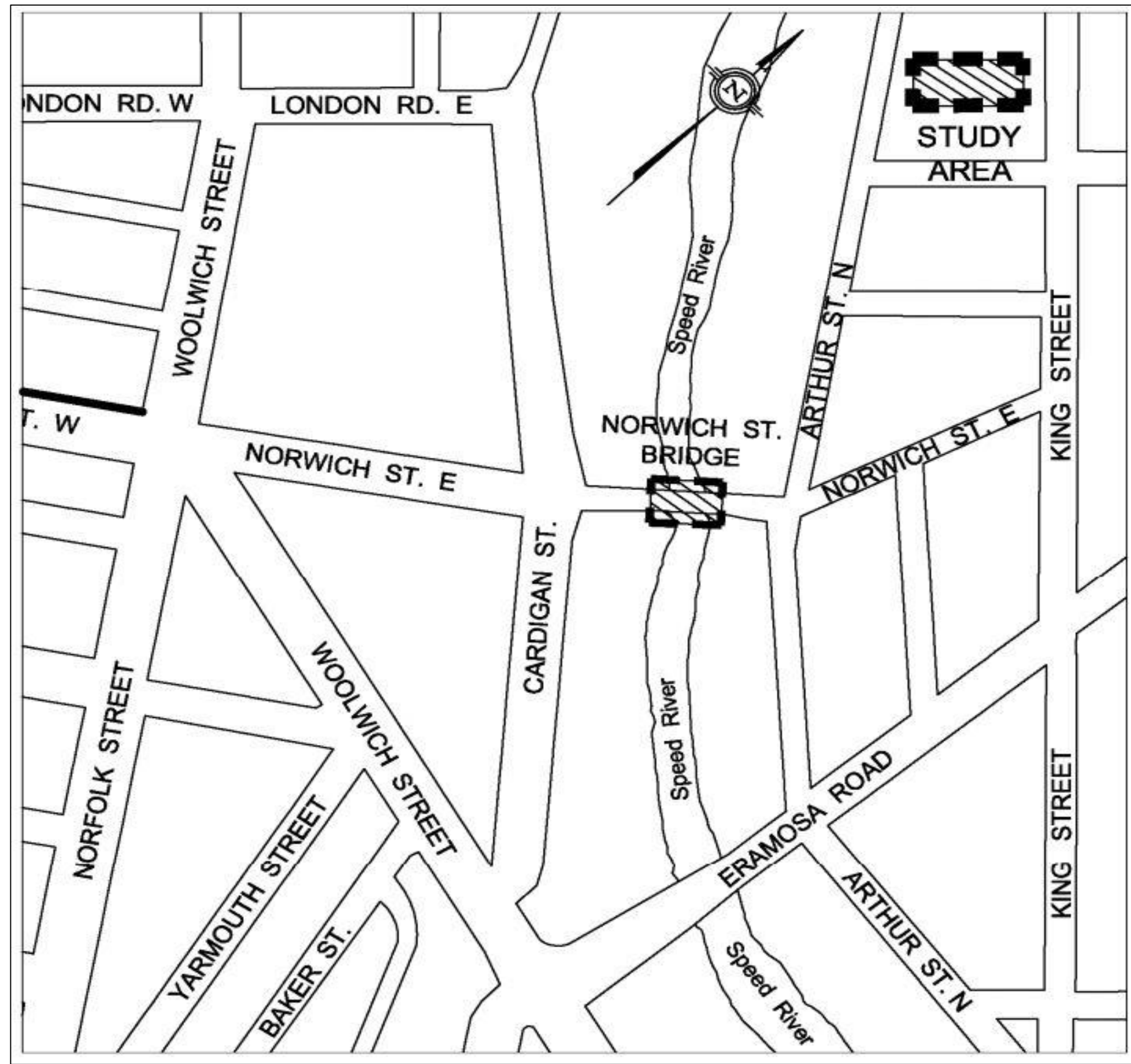



Project Background and Purpose of Open House

Project Background:

- Norwich Street Bridge was built in 1882 to cross the Speed River, and was closed to vehicle traffic in 1998 when the steel bridge and name plates were designated as a heritage structure.
- The bridge currently allows pedestrians to move through the Goldie Mill Neighbourhood and along the Royal Recreation Trail.
- In 2017, an environmental assessment (EA) recommended preserving the existing heritage steel structure and adding a self-supporting structure that carries its own weight to provide safe crossing over the Speed River.

Purpose of this Virtual Open House:

- Provide details of the construction, including the scope, timeline and construction area limits.
- Allow local residents to learn about the construction project and submit comments or questions to the project team.

Overview of Scope of Construction

The reconstruction of the Norwich Street Bridge will include:

- Restoration of the existing heritage steel bridge;
- Repairs to concrete walls;
- Installation of a self-supporting pedestrian bridge between the restored trusses;
- Removal of adjacent footbridge and installation of new support structure for watermain and sanitary sewer; and,
- Reconstruction of the trail approaching the bridge to tie-in to the new pedestrian bridge.

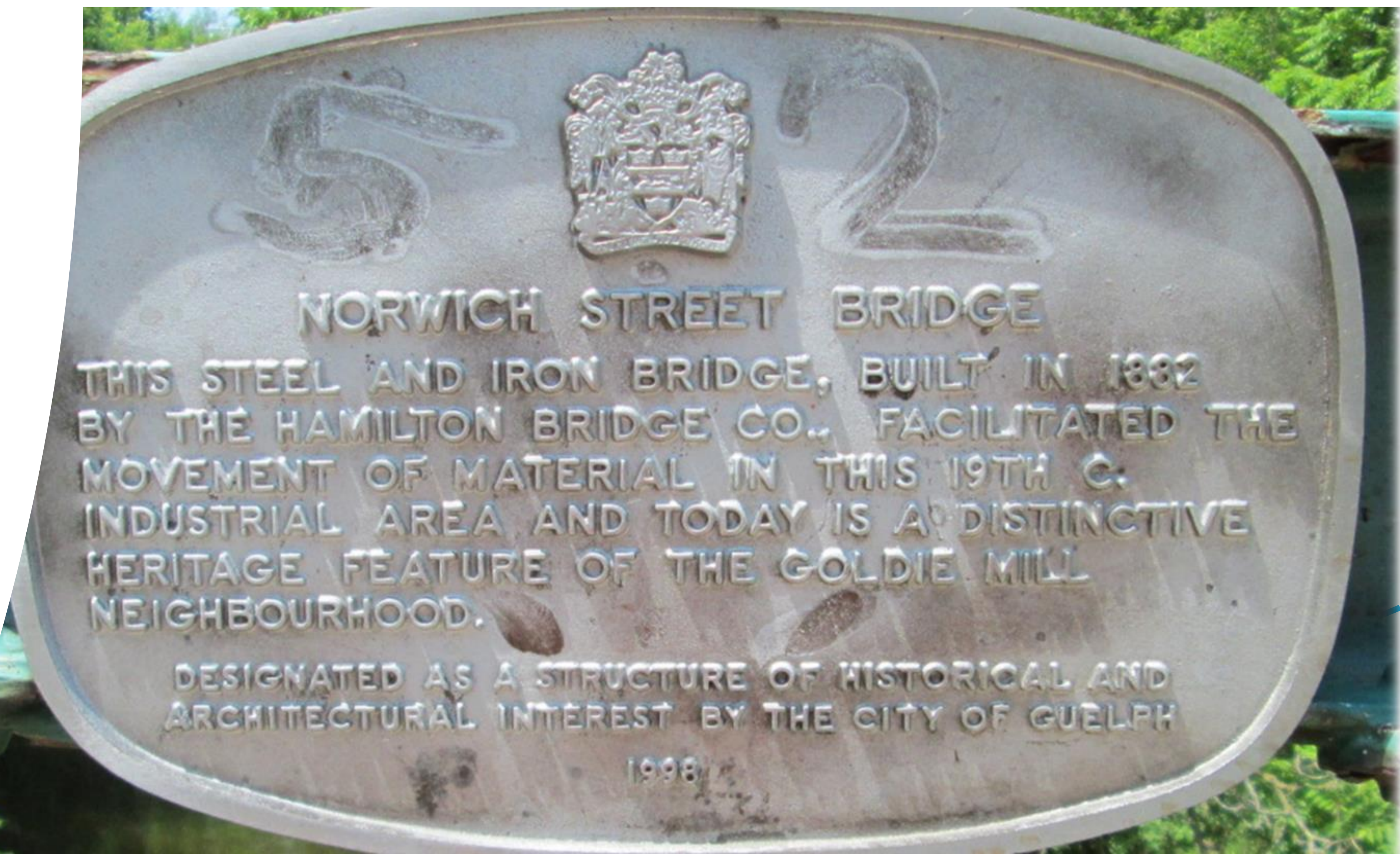

Representation of Proposed Norwich Street Bridge Reconstruction

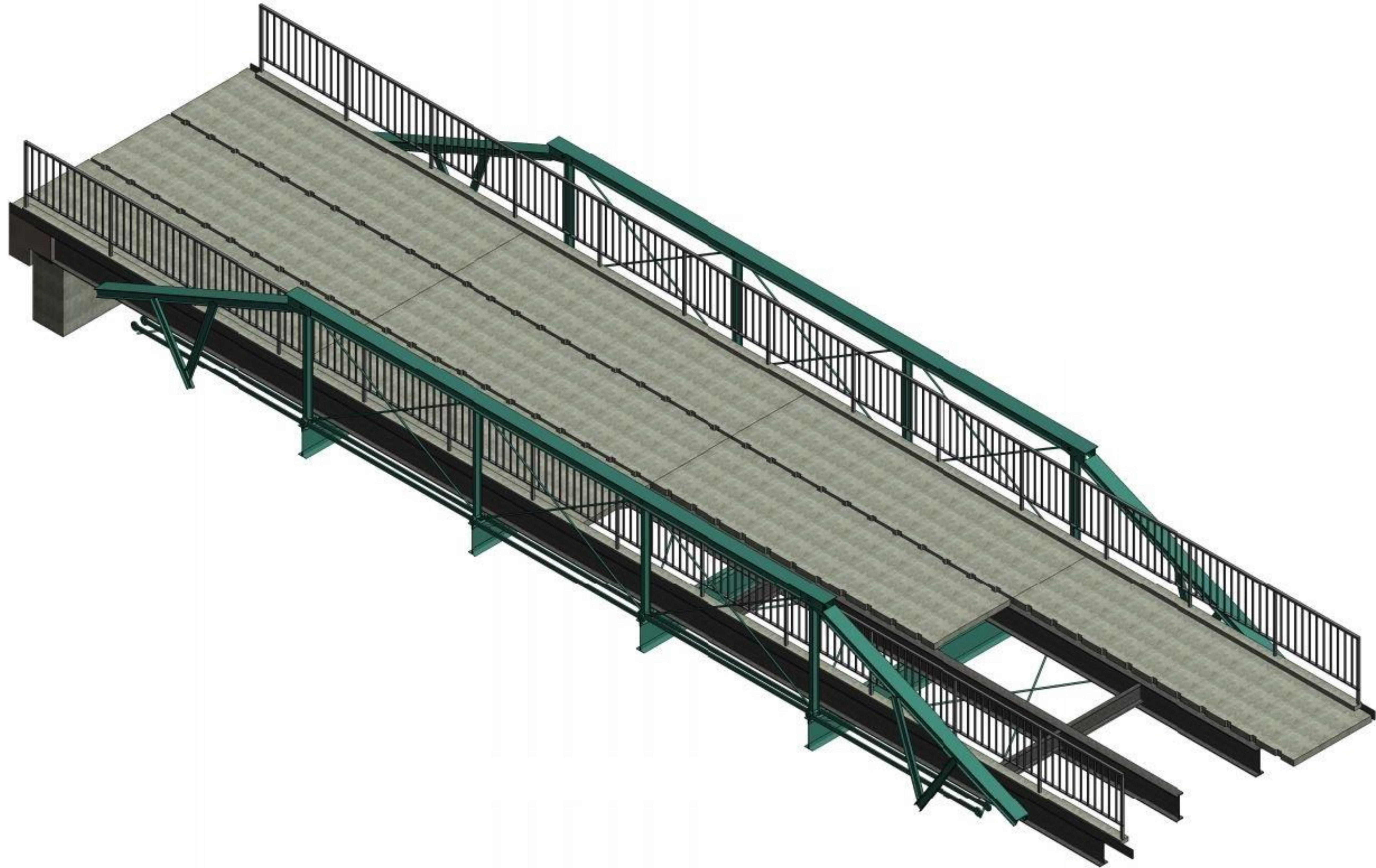

Proposed East Approach of Norwich Street Bridge (Plan View)

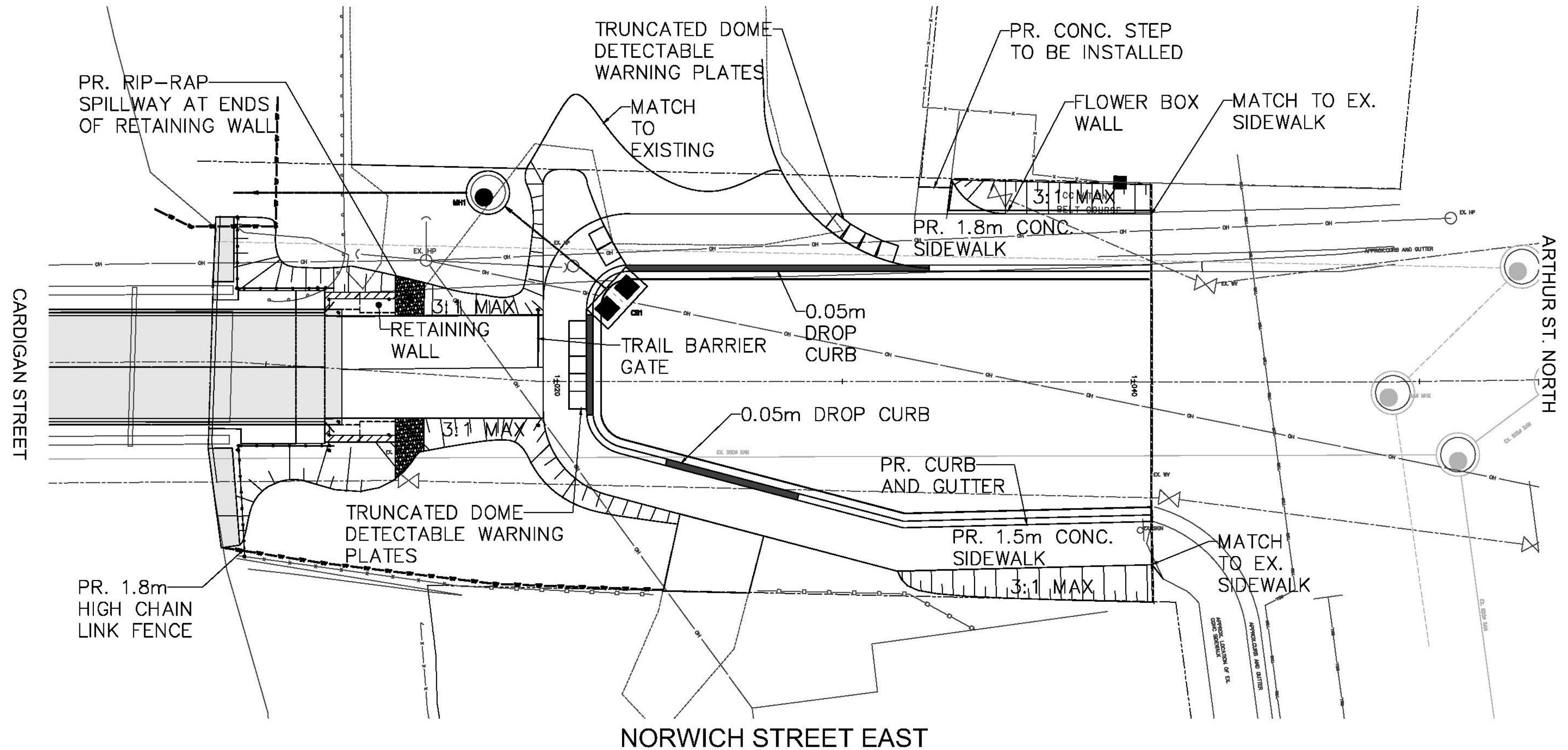

Proposed Norwich Street Bridge Reconstruction (Side View)

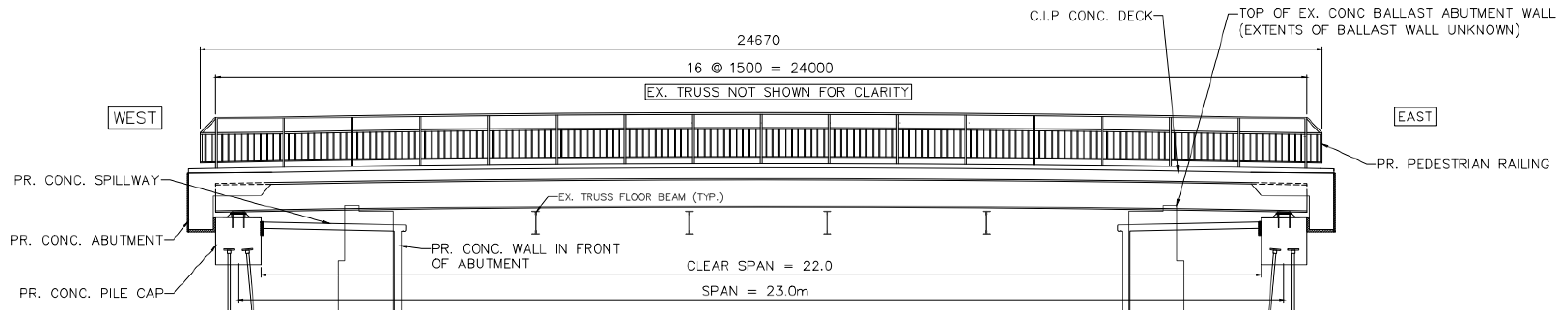

Proposed Norwich Street Bridge Reconstruction (Cross Section View)

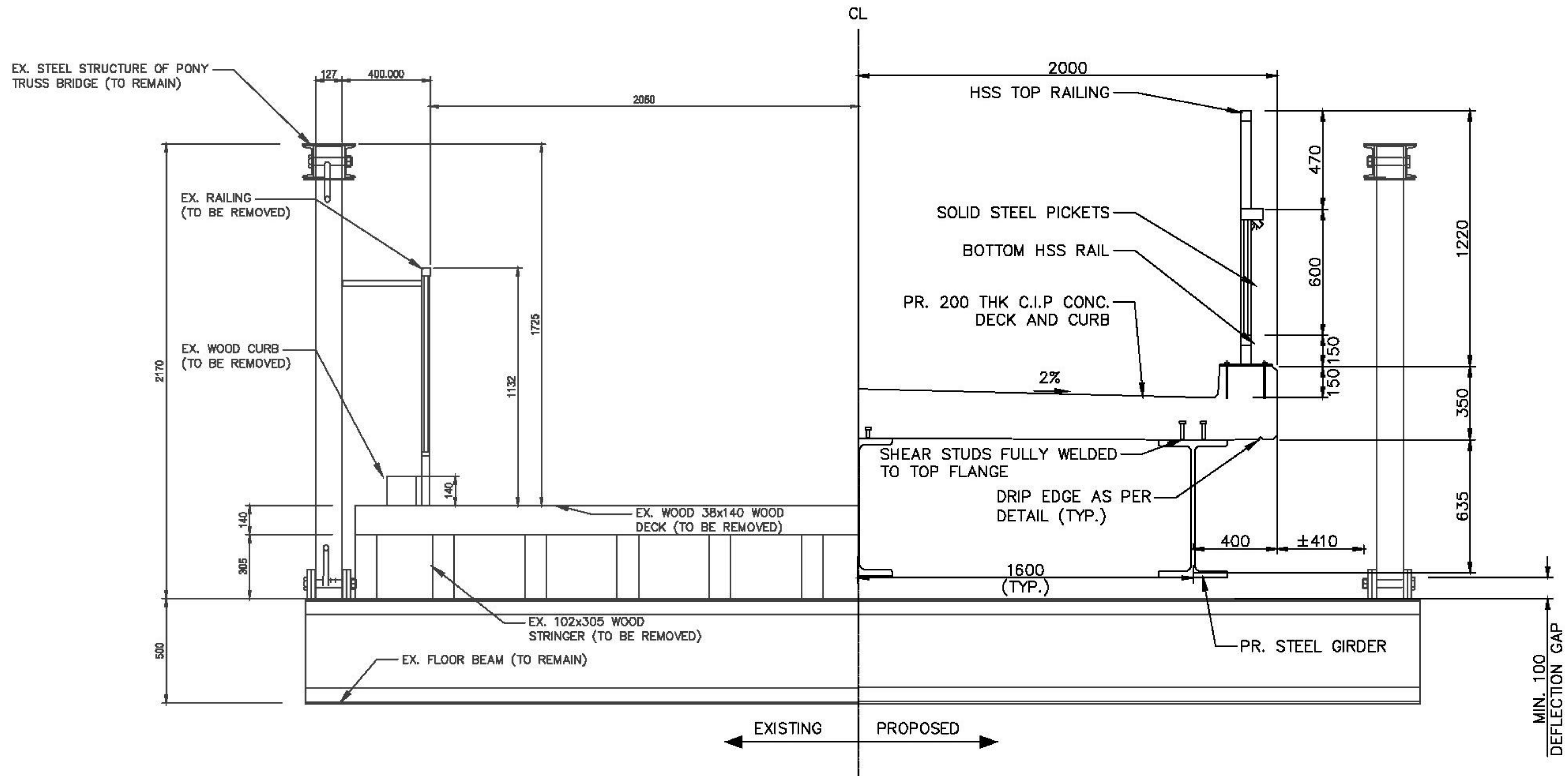

Limits of Construction and Access for Local Residents

During Construction:

- Norwich Street East, west of Arthur Street, will be closed.
- The Norwich Street Parking lot will be closed.
- Construction access will generally be from Arthur Street.
- Access to the Royal Recreation Trail will be maintained, with occasional, temporary, short-term closures.
- The City will coordinate parking with local residents.



Construction Timeline

- Construction is anticipated to start on or about **September 8, 2020** and take approximately **14 weeks** to complete, weather permitting.

September						
S	M	T	W	T	F	S
		1	2	3	4	5
6	7	8	9	10	11	12
13	14	15	16	17	18	19
20	21	22	23	24	25	26
27	28	29	30			

October						
S	M	T	W	T	F	S
				1	2	3
4	5	6	7	8	9	10
11	12	13	14	15	16	17
18	19	20	21	22	23	24
25	26	27	28	29	30	31

November						
S	M	T	W	T	F	S
1	2	3	4	5	6	7
8	9	10	11	12	13	14
15	16	17	18	19	20	21
22	23	24	25	26	27	28
29	30					

December						
S	M	T	W	T	F	S
		1	2	3	4	5
6	7	8	9	10	11	12
13	14	15	16	17	18	19
20	21	22	23	24	25	26
27	28	29	30	31		

Comments / Questions?

**TO SUBMIT A QUESTION OR COMMENT ABOUT THE NORWICH STREET
BRIDGE RECONSTRUCTION PROJECT PLEASE EMAIL OR CALL:**

Ike Umar, C.E.T.

City Project Manager

City of Guelph

519-822-1260 Extension 2242

ike.umar@guelph.ca

Jack Turner, P.Eng.

Consultant Project Manager

GM BluePlan Engineering Limited

226-755-0292

jack.turner@gmblueplan.ca



07.27.2018